

Planning and Development Department
Land Use Planning Division

A D M I N I S T R A T I V E U S E P E R M I T

CITY OF BERKELEY ZONING ORDINANCE
Berkeley Municipal Code, Title 23

AUP #13-2000043

Property Address: **908 THE ALAMEDA**

Permittee Name: **ANDRE WAINWRIGHT**

Use and/or Construction Permitted: to legalize the consolidation of two commercial retail lease spaces into one pursuant to:

- Section 23E.60.050 to convert lease spaces.

FINDINGS, CONDITIONS AND APPROVED PLANS ATTACHED

Following the expiration of the mandatory appeal period set forth in Section 23B.28.040 of the Berkeley Municipal Code, with no timely appeal being filed, the Administrative Use Permit described herein has been duly granted by the Zoning Officer on August 8, 2013.

Attest: Terry Blount
Terry Blount, AICP, Principal Planner
For Debbie Sanderson, Zoning Officer

August 8, 2013
Effective Date

ATTACHMENT 1

FINDINGS AND CONDITIONS

JULY 18, 2013

908 The Alameda

Administrative Use Permit #13-20000043

To legalize the consolidation of two commercial retail lease spaces into one.

CEQA FINDINGS

1. The project is categorically exempt from the provisions of the California Environmental Quality Act (CEQA, Public Resources Code §21000, et seq. and California Code of Regulations, §15000, et seq.) pursuant to Section 15303 of the CEQA Guidelines ("New Construction or the Conversion of Small Structures"). Furthermore, none of the exceptions in CEQA Guidelines Section 15300.2 apply, as follows: (a) the site is not located in an environmentally sensitive area, (b) there are no cumulative impacts, (c) there are no significant effects, (d) the project is not located near a scenic highway, (e) the project site is not located on a hazardous waste site pursuant to Government Code Section 65962.5, and (f) the project will not affect any historical resource.

FINDINGS FOR APPROVAL

2. As required by Section 23B.28.050.A of the Zoning Ordinance, the project, under the circumstances of this particular case existing at the time at which the application is granted, will not be detrimental to the health, safety, peace, morals, comfort, and general welfare of the persons residing or working in the neighborhood of such proposed use or be detrimental or injurious to property and improvements of the adjacent properties, the surrounding area or neighborhood, or to the general welfare of the City because:
 - The combining of two retail spaces will continue to meet the purposes of the Solano Avenue Commercial District in that the conversion will allow the existing business to utilize the space to its fullest potential and continue to offer retail spaces and pedestrian oriented activity.
 - The two spaces have effectively acted as on lease space for at least 20 years with no detrimental effects to the neighborhood.

OTHER REQUIRED FINDINGS

3. As required by Section 23E.60.090.B, the project will:
 - Maintain the character of the street as no exterior alterations are proposed
 - Continue to encourage pedestrian oriented activity and will not create a saturation of one particular kind of use as this application is only for the combining of two lease spaces and does not include a change of use; and
 - The use will help not create an increase in parking or traffic demand as no new floor area will be created and no change of use is proposed.

STANDARD CONDITIONS

The following conditions, as well as all other applicable provisions of the Zoning Ordinance, apply to this Permit:

1. Conditions Shall be Printed on Plans

The conditions of this Permit shall be printed on the *second* sheet of each plan set submitted for a building permit pursuant to this Use Permit, under the title 'Use Permit Conditions'. *Additional sheets* may also be used if the *second* sheet is not of sufficient size to list all of the conditions. The sheet(s) containing the conditions shall be of the same size as those sheets containing the construction drawings; 8-1/2" by 11" sheets are not acceptable.

2. Applicant Responsible for Compliance with Conditions

The applicant shall ensure compliance with all of the following conditions, including submittal to the project planner of required approval signatures at the times specified. Failure to comply with any condition may result in construction being stopped, issuance of a citation, and/or modification or revocation of the Use Permit.

3. Uses Approved Deemed to Exclude Other Uses (Section 23B.56.010)

- A. This Permit authorizes only those uses and activities actually proposed in the application, and excludes other uses and activities.
- B. Except as expressly specified herein, this Permit terminates all other uses at the location subject to it.

4. Modification of Permits (Section 23B.56.020)

No change in the use or structure for which this Permit is issued is permitted unless the Permit is modified by the Zoning Officer, except that the Zoning Officer may approve changes that do not expand, intensify, or substantially change the use or building.

5. Plans and Representations Become Conditions (Section 23B.56.030)

Except as specified herein, the site plan, floor plans, building elevations and/or any additional information or representations, whether oral or written, indicating the proposed structure or manner of operation submitted with an application or during the approval process are deemed conditions of approval.

6. Subject to All Applicable Laws and Regulations (Section 23B.56.040)

The approved use and/or construction is subject to, and shall comply with, all applicable City Ordinances and laws and regulations of other governmental agencies. Prior to construction, the applicant shall identify and secure all applicable permits from the Building and Safety Division, Public Works Department and other affected City divisions and departments.

7. Exercised Permit for Use Survives Vacancy of Property (Section 23B.56.080)

Once a Permit for a use is exercised and the use is established, that use is legally recognized, even if the property becomes vacant, except as set forth in Standard Condition #8, below.

8. Exercise and Lapse of Permits (Section 23B.56.100)

- A. A permit for the use of a building or a property is exercised when, if required, a valid City business license has been issued, and the permitted use has commenced on the property.
- B. A permit for the construction of a building or structure is deemed exercised when a valid City building permit, if required, is issued, and construction has lawfully commenced.
- C. A permit may be declared lapsed and of no further force and effect if it is not exercised within one year of its issuance, except that permits for construction or alteration of structures or buildings may not be declared lapsed if the permittee has: (1) applied for a building permit; or, (2) made substantial good faith efforts to obtain a building permit and begin construction, even if a building permit has not been issued and/or construction has not begun.

9. Indemnification Agreement

The applicant shall hold the City of Berkeley and its officers harmless in the event of any legal action related to the granting of this Permit, shall cooperate with the City in defense of such action, and shall indemnify the City for any award of damages or attorneys fees that may result.

ADDITIONAL CONDITIONS IMPOSED BY THE ZONING OFFICER

Pursuant to BMC 23B.28.050.D, the Zoning Officer attaches the following additional conditions to this Permit:

Prior to Submittal of Any Building Permit:

- 10.** The applicant shall provide the project planner with the name and telephone number of the individual empowered to manage construction noise from the project. The individual's name, telephone number, and responsibility for noise management shall be posted at the project site for the duration of construction in a location easily visible to the public. The individual shall record all noise complaints received and actions taken in response, and submit written reports of such complaints and actions to the project planner on a weekly basis. **Individual Responsible for Noise Management:**

Name: _____ Phone: _____

- 11.** The applicant and all persons associated with the project are hereby notified that a Transportation Management Permit (TMP) would be required under any of the following circumstances:

- Alterations, closures, or blockages to sidewalks or pedestrian paths

- Alterations, closures, or blockages to vehicle travel lanes (including bicycle lanes)
- Storage of building materials, dumpsters, debris anywhere in the public ROW
- Provision of exclusive contractor parking on-street
- Significant truck activity.

Contact the Permit Service Center (PSC) at 2120 Milvia Street or 981-7500 for details on obtaining Construction/No Parking Permits (and associated signs and accompanying dashboard permits). Public Works Traffic Engineering (981-6400) reviews all submitted TMP requests.

The TMP may include designation of a specific truck haul route. Meter heads (if in the construction area) shall be removed only by City staff. Contact the site inspector 72 hours in advance of required removal so arrangements can be made.

Prior to Issuance of Any Building Permit:

12. Drainage plans shall be submitted for approval of the Building & Safety Division and Public Works Department, if required.
13. The applicant shall file an "Address Assignment Request Application" with the Permit Service Center (2120 Milvia Street) to remove the extra address associated with this conversion.
14. Any construction during the wet season shall require submittal of a soils report with appropriate measures to minimize erosion and landslides, and the developer shall be responsible for following these and any other measures required by the Building and Safety Division and the Public Works Department.

Prior to Issuance of Occupancy Permit or Final Inspection:

15. All construction at the subject property shall substantially conform to the approved Use Permit drawings or to modifications approved by the Zoning Officer.
16. All landscape, site and architectural improvements shall be completed per the attached approved drawings dated **APRIL 1, 2013**.

At All Times (Operation):

17. All exterior lighting shall be shielded and directed downward and away from property lines to prevent excessive glare beyond the subject property.
18. This permit is subject to review, imposition of additional conditions, or revocation if factual complaint is received by the Zoning Officer that the maintenance or operation of this establishment is violating any of these or other required conditions or is detrimental to the health, safety, peace, morals, comfort or general welfare of persons residing or working in the neighborhood or is detrimental or injurious to property and improvements in the neighborhood or to the general welfare of the City.

19. Noise and exterior lighting shall be controlled so as to prevent verified complaints from the surrounding neighborhood. This shall include noise created by employees working on the premises before or after patrons arrive.



Prepared by: Claudine Asbagh, Assistant Planner for
Debra Sanderson, Zoning Office



TECTA

ASSOCIATES
ARCHITECTURE
INTERIORS
PLANNING

2747 MISSION STREET
SAN FRANCISCO, CA 94110
Tel. 415-362-6567
Fax. 415-362-5044
WWW.TECTA.COM



THE ALAMEDA
MIXED USE BUILDING
908 THE ALAMEDA
BERKELEY, CA 94707

NO.	REVISION	DATE
1	ISSUED FOR PERMIT	07/15/2013
2	REVISED PER COMMENTS	08/02/13

OWNER: THE ALAMEDA
ARCHITECT: TECTA ASSOCIATES
DATE: 08/02/13

A-1

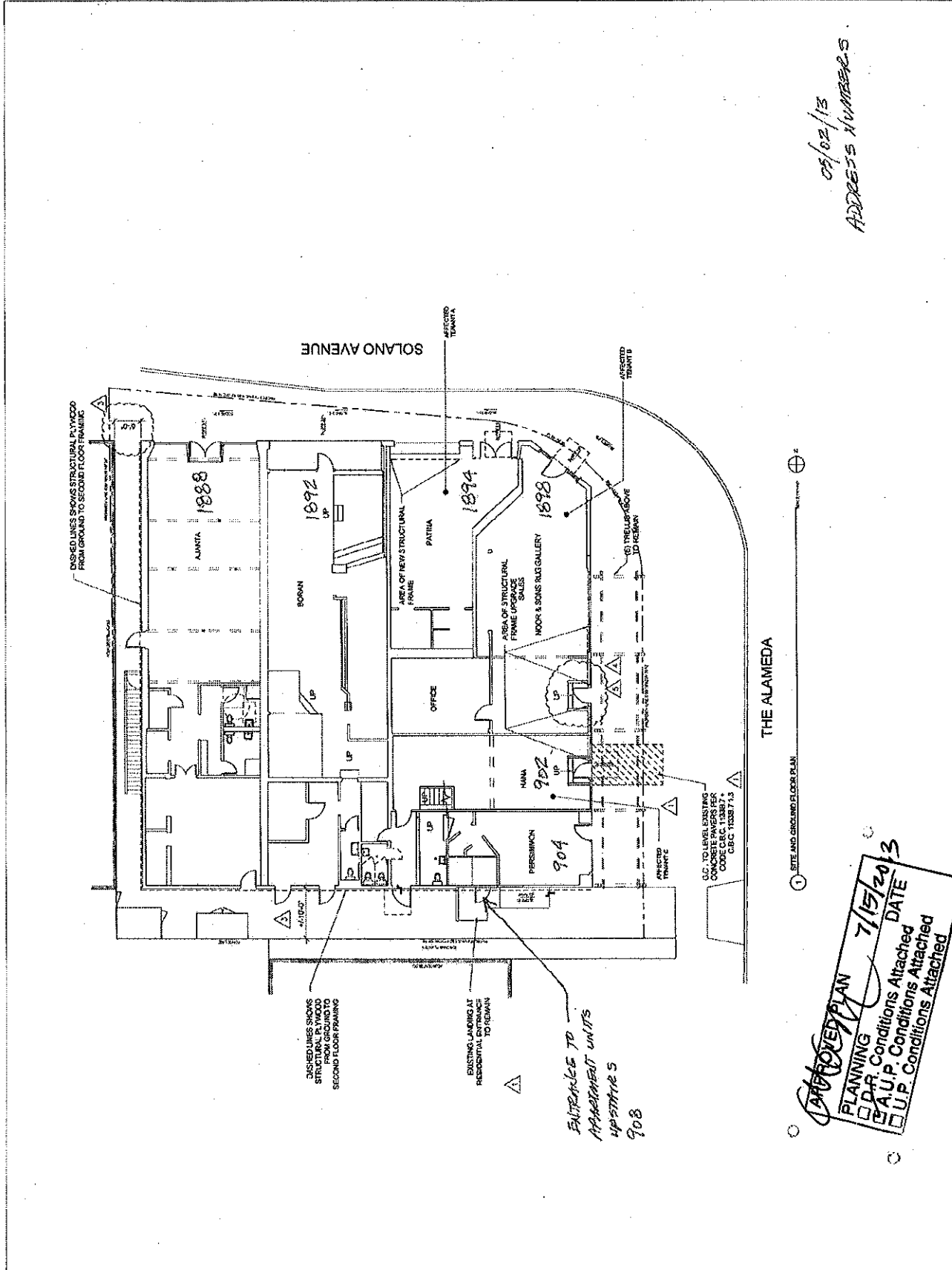

08/02/13
ADDRESS NUMBERS

APPROVED PLAN
 PLANNING 7/15/2013
 DR Conditions Attached
 A.U.P. Conditions Attached
 U.P. Conditions Attached