

Berkeley Civic Center

Open House

November 16, 2022

SIEGEL & STRAIN Architects

Gehl ecb

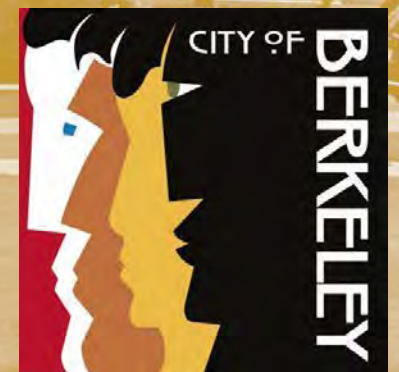

Direction from City Council - Design Concept

Provide additional public process, planning and design to develop a preferred design concept and a funding plan.

Direction from 6/01/21 City Council Consent Calendar Item regarding Phase 2 of City Center District Visioning Resolution No. 69,579-N.S.

- 1** Develop design concept for the Civic Center District based on input from the community, city commissions and City Council.
- 2** Engage the community in evaluating design alternatives and developing a preferred design concept for future planning.
- 3** **BE IT FURTHER RESOLVED** by the Council of the City of Berkeley that the City Manager is hereby authorized to further the implementation of the plan and its ambitious vision for the future of Berkeley's Civic Center.

Agenda

01 Welcome + Introductions

02 Presentation

- Overview of 2019/2020 Vision Plan effort
- Update on current effort
- Design concepts

03 Stations

- Martin Luther King Jr. Civic Center Park
- Surrounding Streets
- Maudelle Shirek Building
- Veterans Memorial Building

Project Schedule

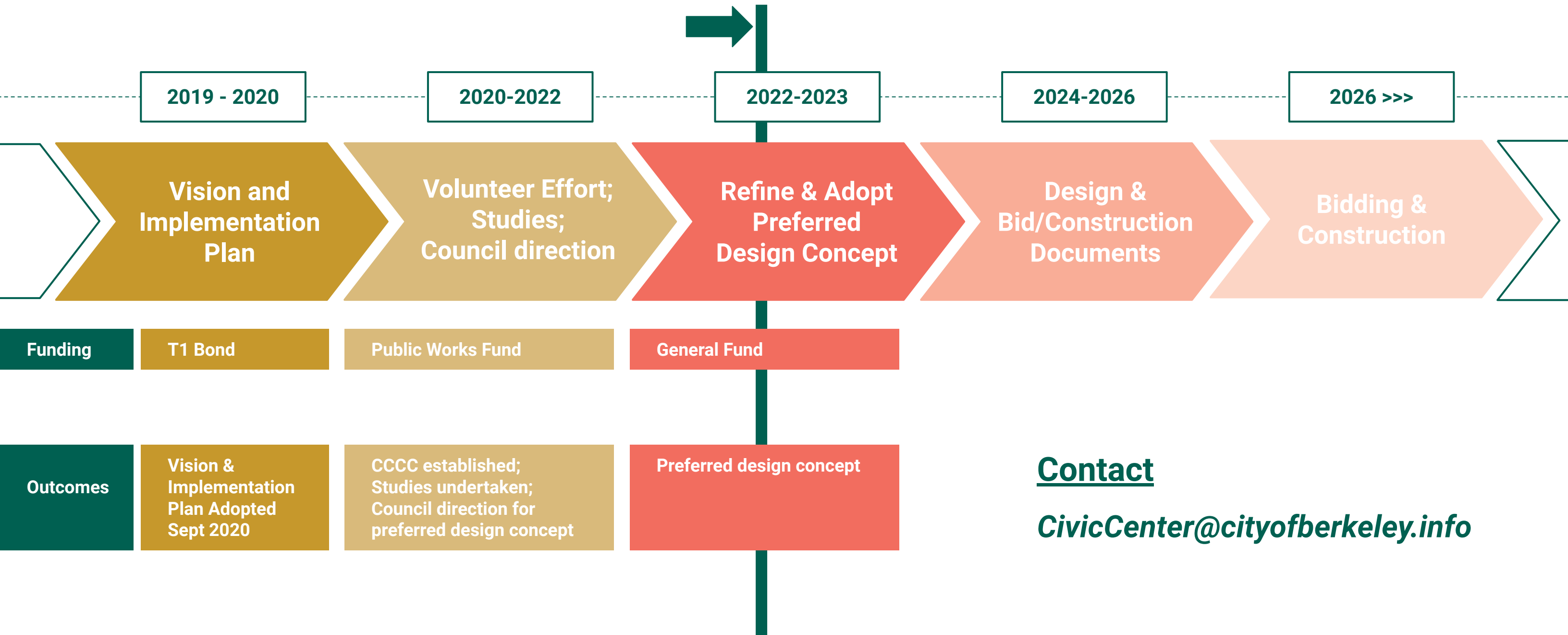

Contact

CivicCenter@cityofberkeley.info



2019-2020

Berkeley Civic Center Vision Plan

Purpose: Develop a bold yet pragmatic vision and implementation plan for the future of Berkeley's Civic Center informed by public input and research.

Planning Area

The Berkeley Civic Center planning area includes:

- Martin Luther King Jr. Civic Center Park
- Surrounding Streets
 - MLK Jr. Way
 - Center Street
 - Allston Way
- Maudelle Shirek Building
- Veterans Memorial Building

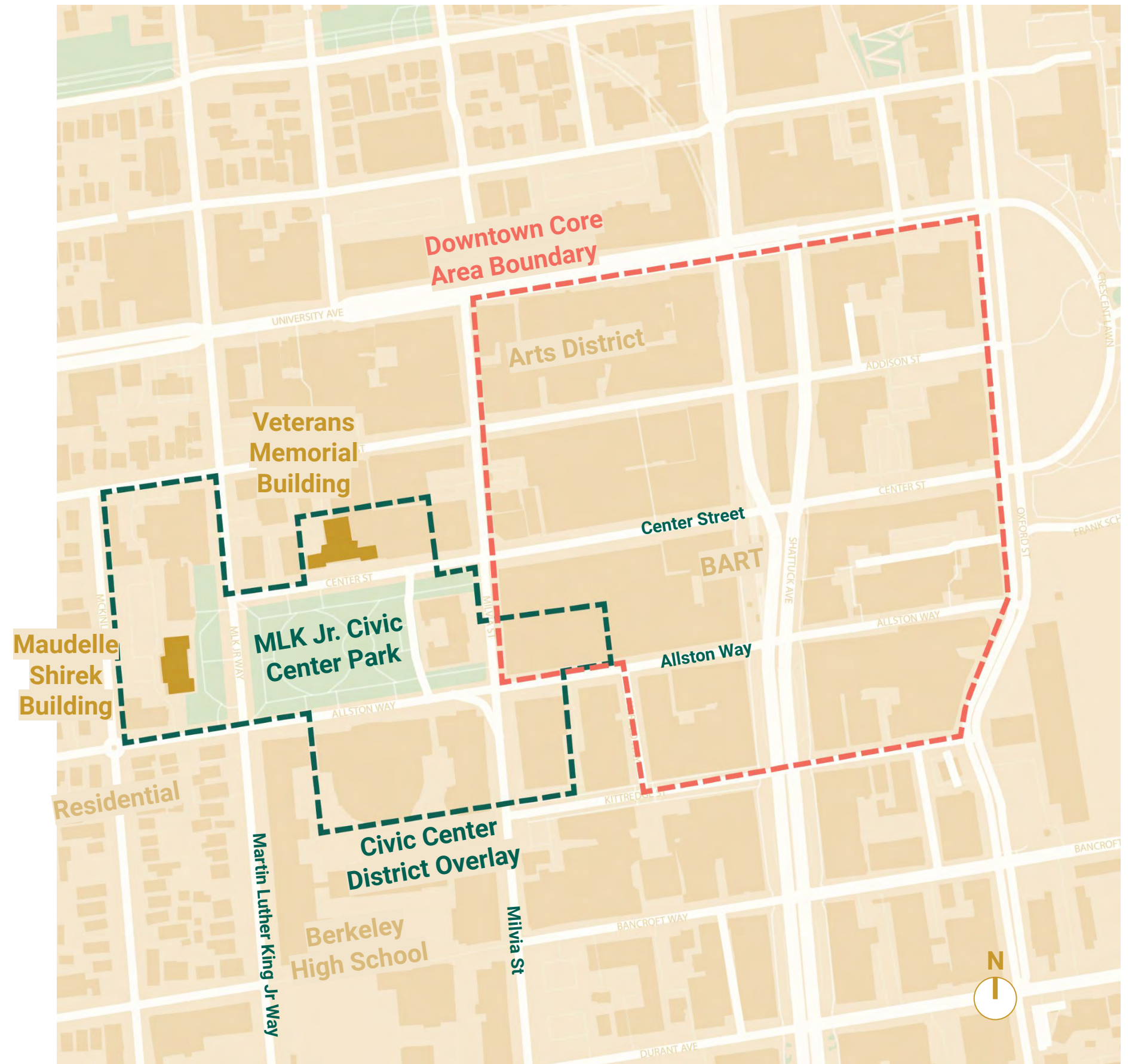



30
Participants in Building Tours with Berkeley Historical Society
Sep 2019 & Mar 2020



21
Volunteers for Public Space, Public Life Survey
Oct 2019



VISION PLAN

40
Participants at Visions & Values Community Meeting
Dec 2019



40+
Interviewees at Focused Engagement Sessions

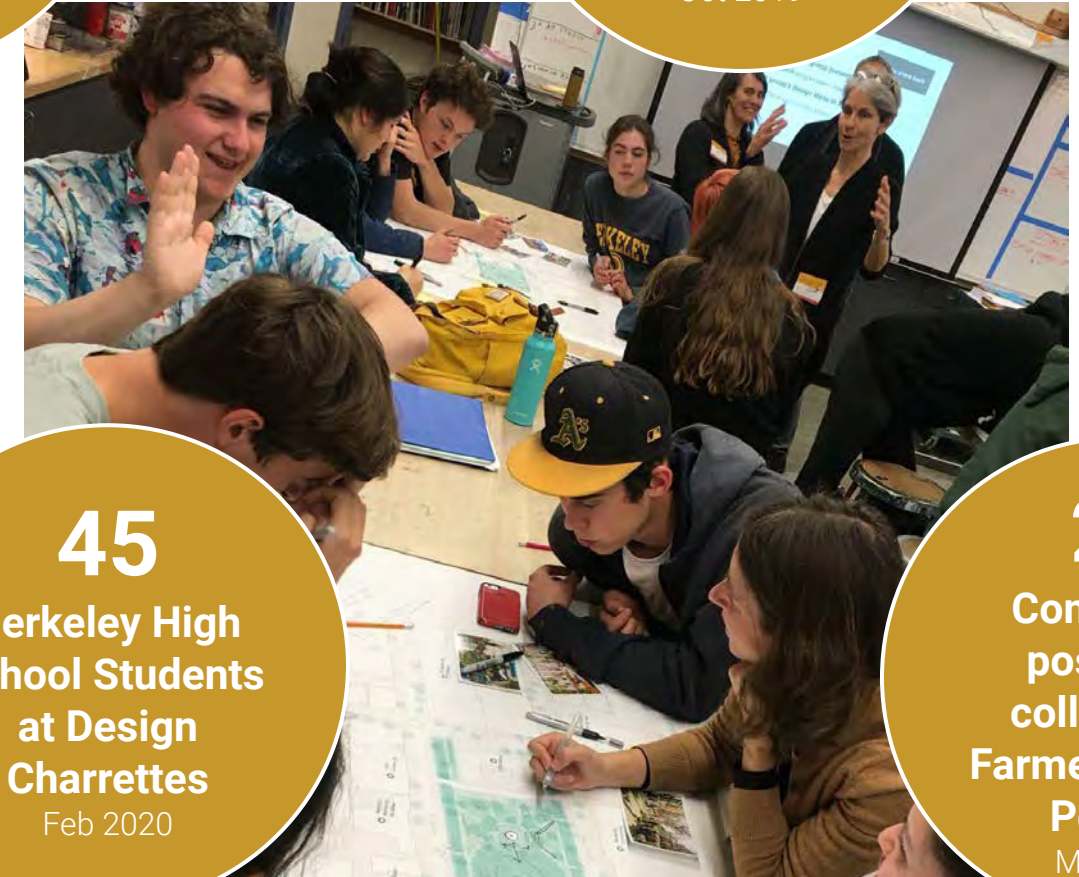

45
Berkeley High School Students at Design Charrettes
Feb 2020



26
Community postcards collected at Farmers Market Pop-Up
Mar 2020

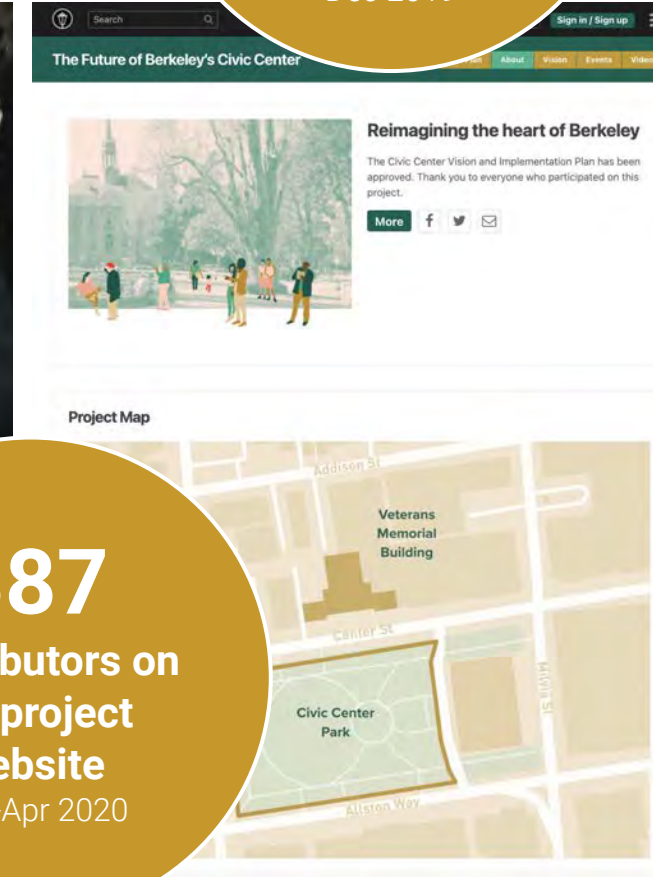

387
Contributors on the project website
Feb -Apr 2020



Visions & Values Community Meeting
 Generating ideas about programming for a future Civic Center (Dec 2019)



POSTCARDS FROM CIVIC CENTER IN 2030 expressed

- a sense of **community**
- appreciation of **historic buildings**
- **modern amenities**
- spaces for **gathering, celebrating & enjoying performing arts.**

VALUES

at the core of the Civic Center

- **Inclusion & Gathering**
- **Equity, Accessibility, and Diversity**

Considered Uses

Primary Use

Secondary Use

Use to be Confirmed



Veterans Memorial Building
Community Arts Center



Maudelle Shirek Building
City & Mission-Aligned Uses



Civic Center Park
Destination for Daily Use & Special Events

Historic Structures & Landscape Reports



Veterans Memorial Building



- Historic integrity of the building is very good; building is in fair shape
- Requires seismic strengthening
- Building exterior has consistent cracking and staining
- The building interior shows sign of excessive water damage & deferred maintenance

Maudelle Shirek Building



- Historic integrity of the building is very good; building is in fair shape
- Requires seismic strengthening
- Inappropriate exterior building materials
- Deferred maintenance
- Damage to exterior building elements
- Overgrown planting at perimeter

Martin Luther King Jr. Civic Center Park

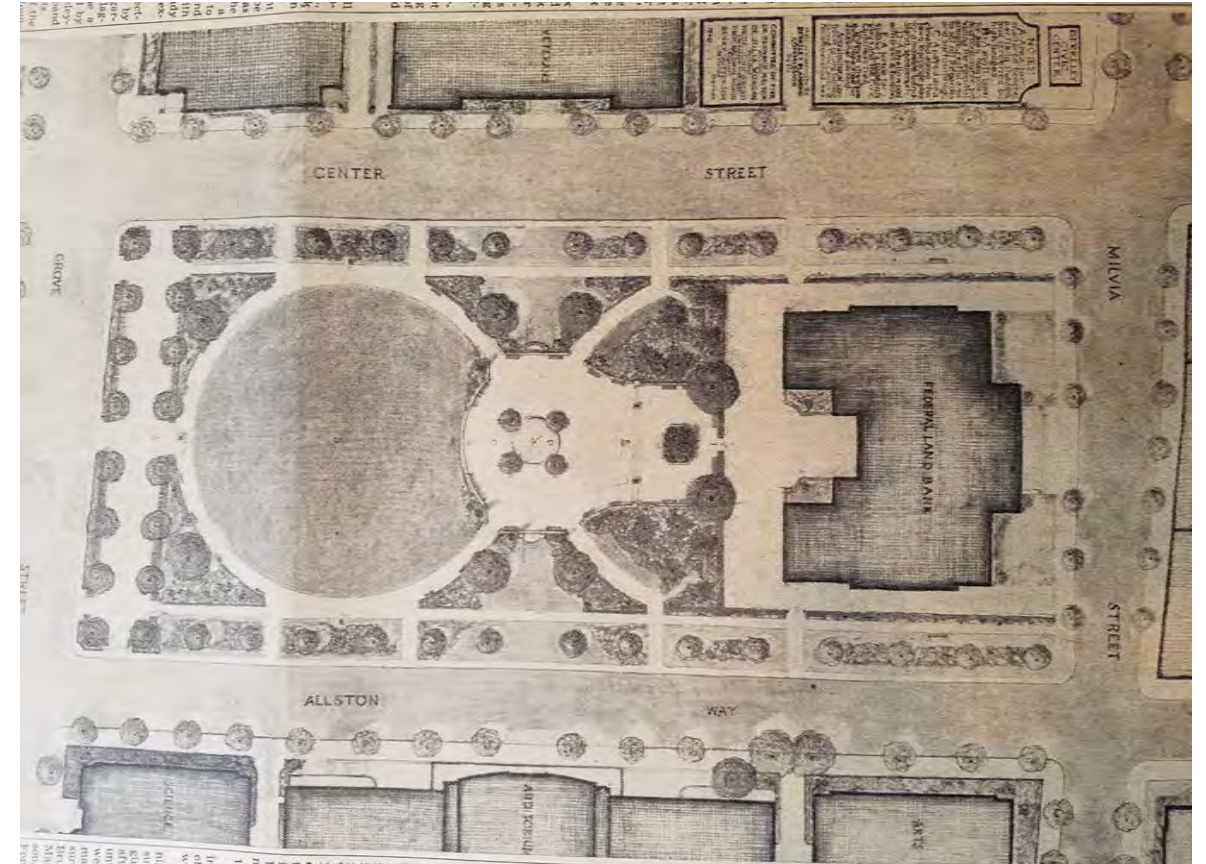

- Overall layout remains largely unchanged
- Changes to accessory functions over time (skateboard, playground)
- Plantings have matured and require attention

Analyzing Berkeley Civic Center



Public Space, Public Life



People Moving



**Mode
Movement Counts**



**Age & Gender
Movement Counts**

People Staying



**Stationary
Activity Mapping**

Existing Strengths

1

Proximity to Downtown, Berkeley High School, Berkeley City College, and City offices supports the need for useful and beautiful outdoor spaces for daily use

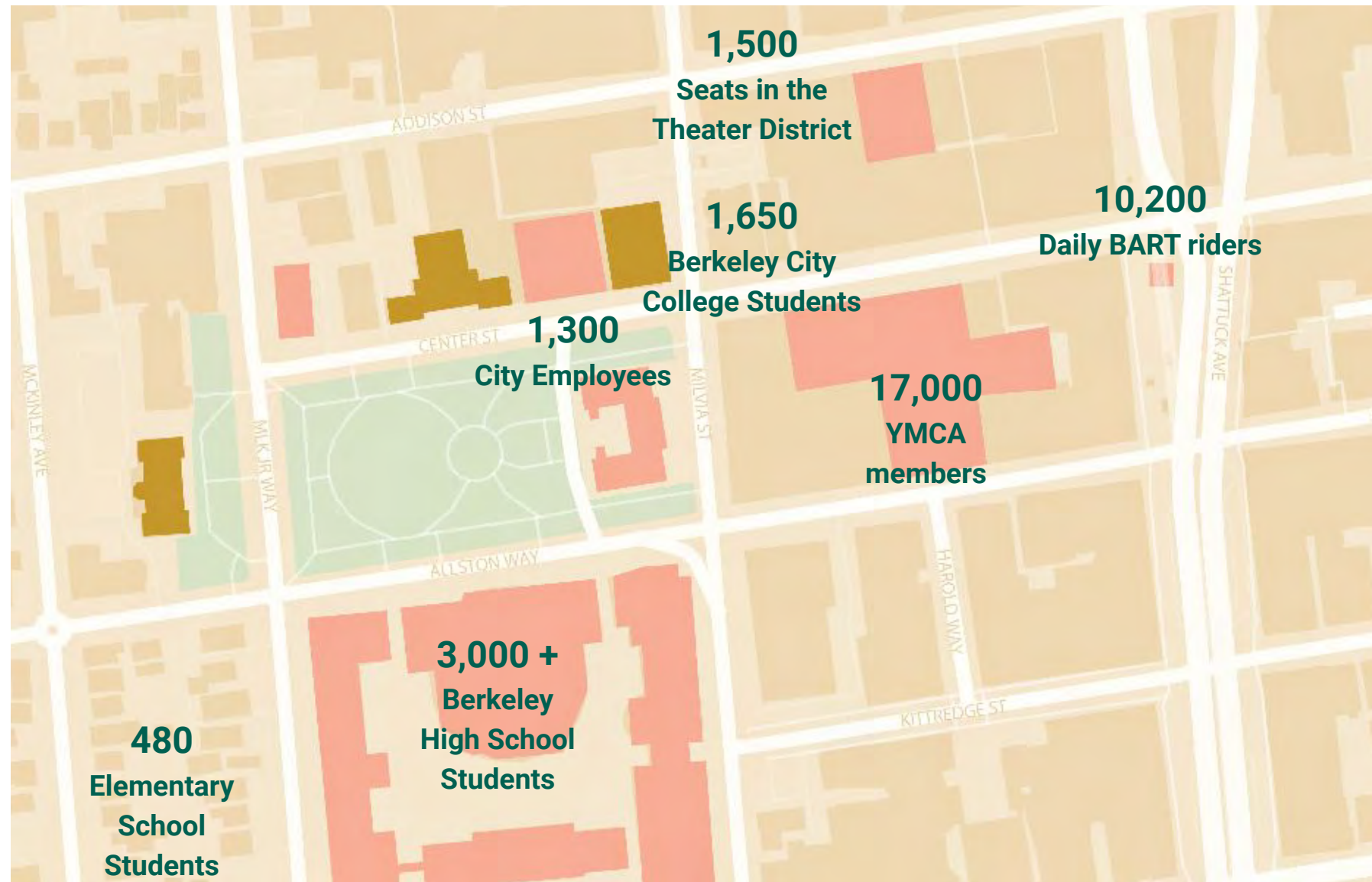

Existing Strengths

2

Large open space
functions well for special
events and civic
gatherings



Civic Center is a key venue for gatherings & public demonstrations



The central green can accommodate a variety of large events

Existing Strengths

3

Mature trees are an irreplaceable asset, and create quiet intimate spaces



Existing trees help define park spaces and symmetry



Tree canopy creates shaded outdoor rooms

Existing Challenges

1

The park feels empty and underutilized.

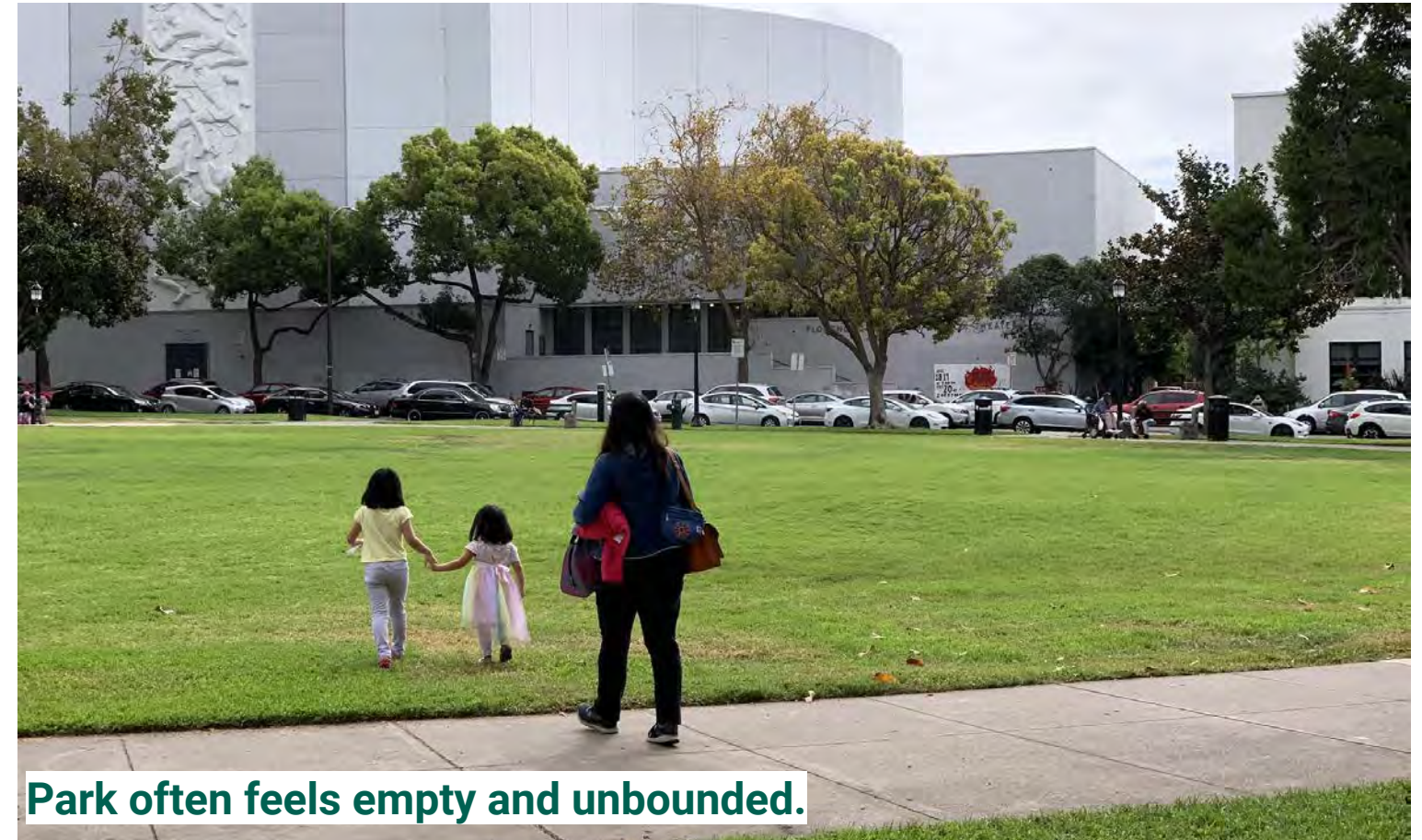

Park often feels empty and unbounded.



Park is rung by parked vehicles without a welcoming entry.

Existing Challenges

2

The park lacks appropriate seating and comfortable spaces that invite people to stay.



Existing Challenges

3

Civic Center is missing park features that give it vibrancy on a typical day.





What we heard – in summary

Today

Civic Center is not a destination and is not on people's mental map. There's not enough of a draw.

Concerns about the conditions and safety of the buildings.

The park is underused, uninviting and lacks the right infrastructure.

Future

A city needs a central civic space. This is our commons.

The Berkeley Civic Center should be a place designed for civic participation, cultural events, community interaction, and where one can sit and relax.

The Park and the buildings should be used by the community.

Everyone should feel comfortable at Civic Center.

The presence of youth is positive.

City Council meetings should be in Civic Center.

ADOPTED!

A Vision for Berkeley's Civic Center



Civic Center will be the heart of Berkeley's community. Civic Center will be the prime space for civic life, culture, and the arts. It will reflect the city's diverse identities, celebrating its history and contributing to shaping its future. A place of shared resources and a platform for free expression accessible to all, the Civic Center aims to manifest the city's values, advance social justice, and demonstrate the power of true public space.

From Berkeley Civic Center Vision & Implementation Plan dated July 10, 2020 and adopted by Berkeley City Council on September 22, 2020

2020-Present

What has happened since 2020

Policy updates



Vision 2050

Equity, Public Health & Safety, Strong Local Economy, Resiliency & Sustainability (May 2020)



Existing Buildings Electrification Strategy

(November 2021)



Native Species Policy

Native, Drought-Resistant, Pollinator-Friendly (April 2022)

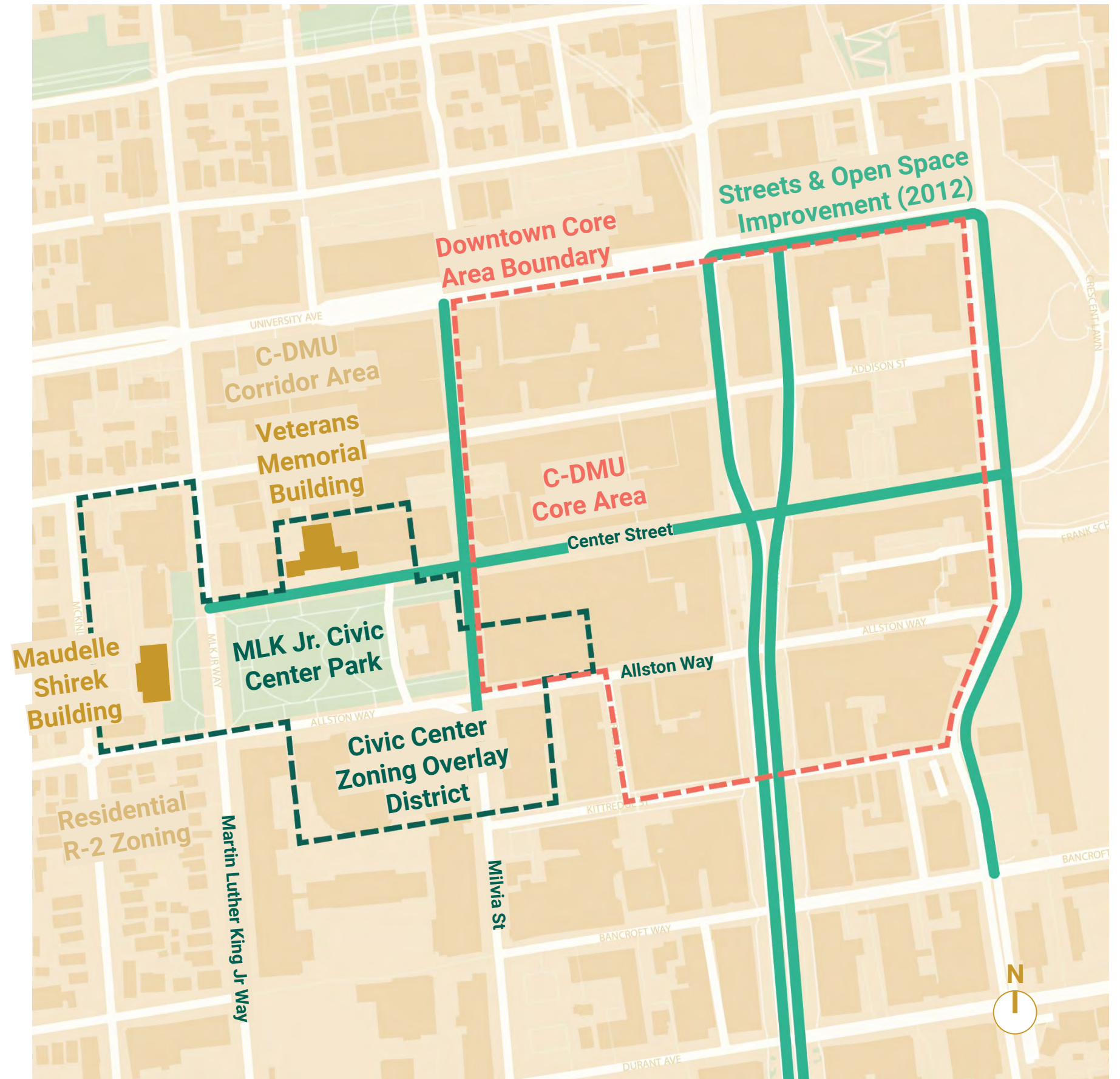

Circulation context

1. **Milvia Bicycle Boulevard & Berkeley High School Loading** (Completed May 2022)
2. **Center Street Greenway & Allston Way Civic Street** (Streets and Open Space Improvement Plan 2012-23)
3. **Center Street Parking Garage and BART Bike Parking**
4. **Pedestrian Signal & Crosswalk Bulbout Improvements** (Pedestrian Master Plan 2019-20)



Input since 2020

1. **Seismic Retrofit Study by Tipping** (exploration of alternate Seismic approaches)
2. **Turtle Island Monument** (Grant funded)
3. **Meeting Hall / Council Chambers** (CCCC/others preference for MSB location or remain at BUSD Board Room)
4. **More Planting, Less Paving** (CCCC preference for integration of native species & biodiversity, preservation of existing tree canopy, inclusion of a large green open space)
5. **Park Performance Venues** (CCCC/ELS study for integrating two performance venues into existing park organization)
6. **Remove parking lot** (behind 2180 Milvia)
7. **CCCC Additional Items for exploration**
 - a. Street Treatment
 - b. Daylighting Strawberry Creek

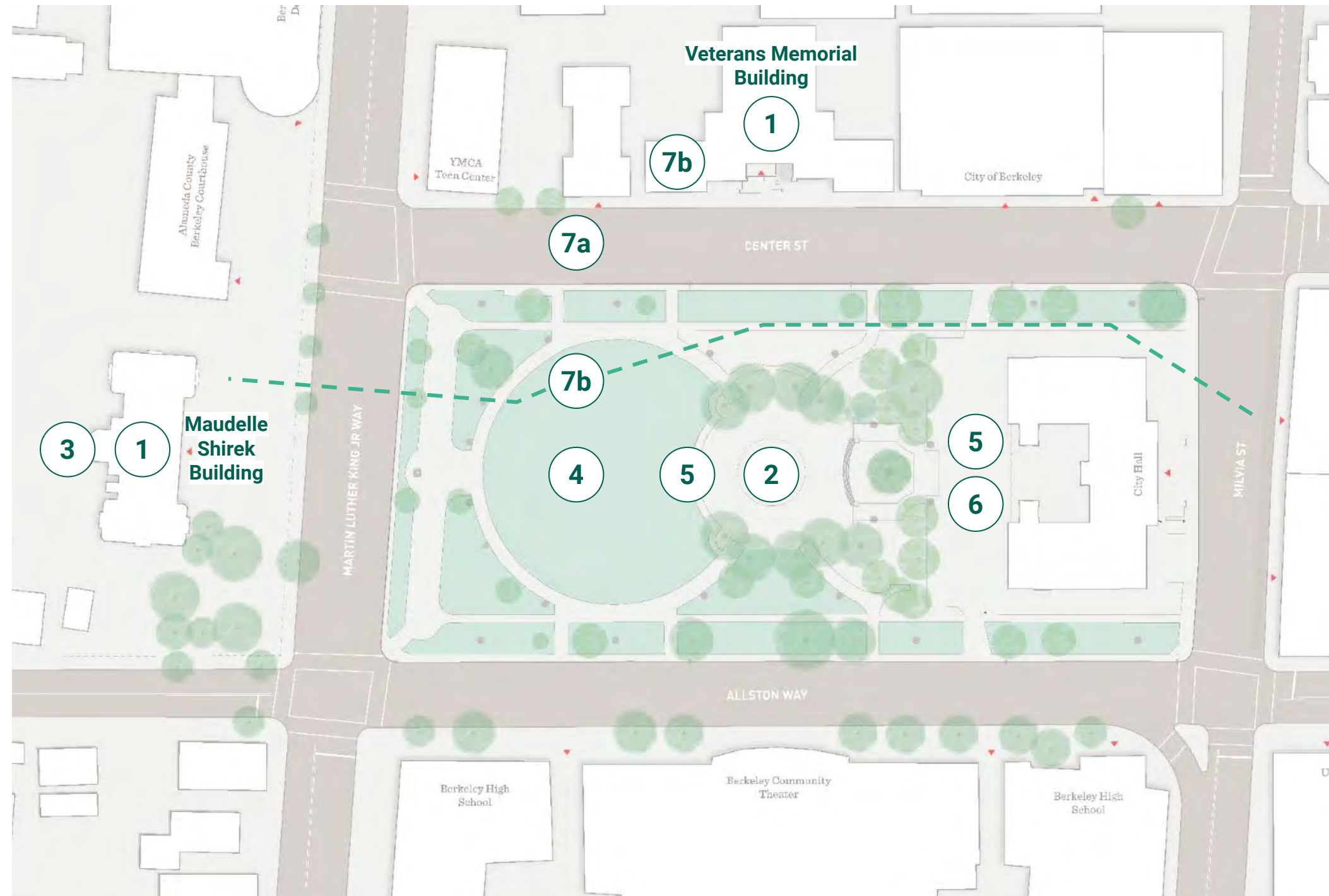

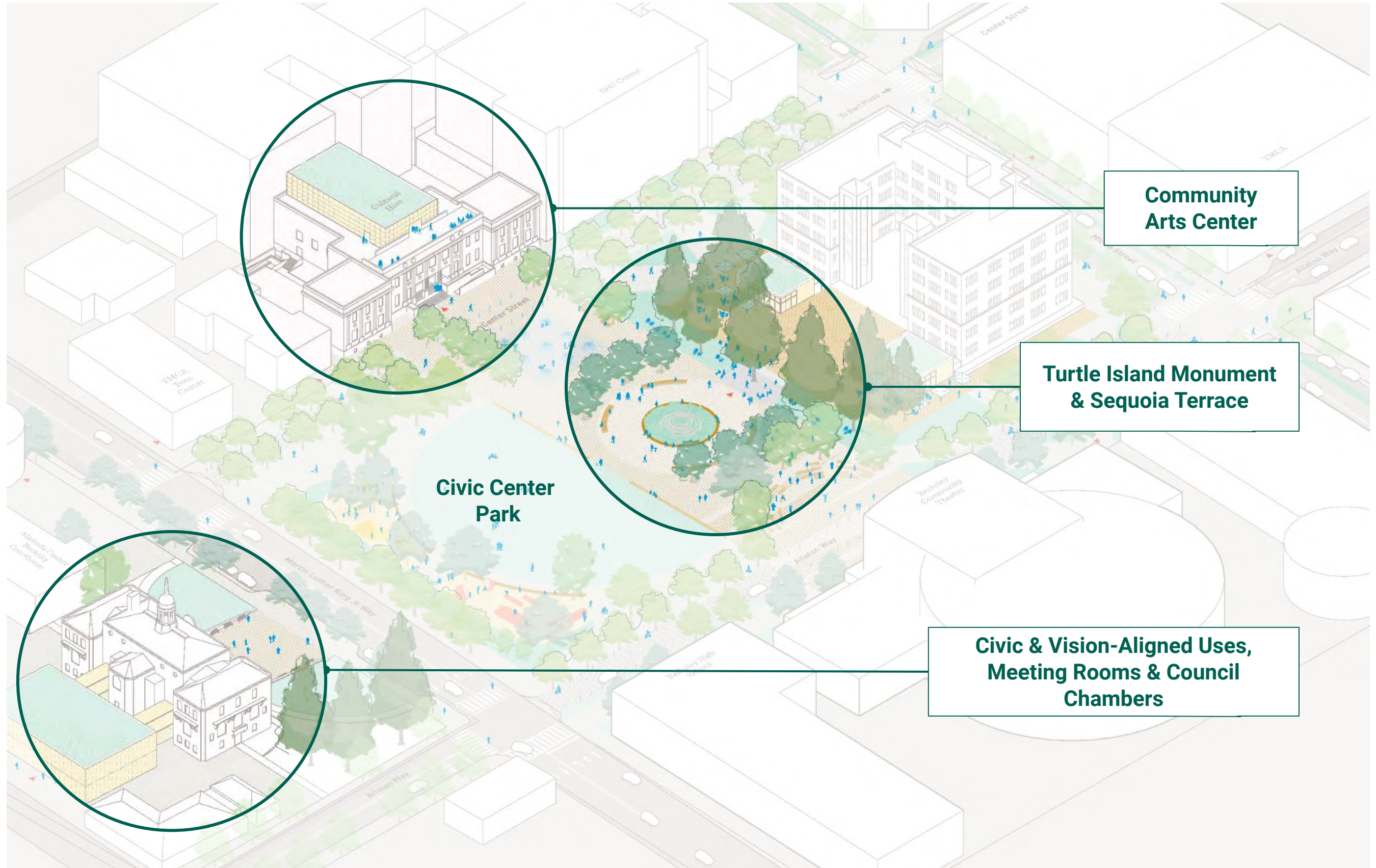

ADOPTED!

A Vision for Berkeley's Civic Center

Civic Center will be the heart of Berkeley's community. Civic Center will be the prime space for civic life, culture, and the arts. It will reflect the city's diverse identities, celebrating its history and contributing to shaping its future. A place of shared resources and a platform for free expression accessible to all, the Civic Center aims to manifest the city's values, advance social justice, and demonstrate the power of true public space.



From Berkeley Civic Center Vision & Implementation Plan dated July 10, 2020 and adopted by Berkeley City Council on September 22, 2020

Berkeley Civic Center

Martin Luther King Jr.

Park

Approach 1: Upgrade lawn & terrace to better host large events

“Civic Center will be the heart of Berkeley’s community. Civic Center will be the prime space for civic life, **culture, and the arts.**”

It will reflect the city’s diverse identities, celebrating its history and contributing to shaping its future.

A place of shared resources and a platform for free expression accessible to all, the Civic Center aims to manifest the city’s values, advance social justice, and demonstrate the power of true public space.”



Legend

★ Outdoor stage locations

Approach 2: Addition of a small performance venue

“Civic Center will be the heart of Berkeley’s community. Civic Center will be the prime space for civic life, **culture, and the arts.**”

It will reflect the city’s diverse identities, celebrating its history and contributing to shaping its future.

A place of shared resources and a platform for free expression accessible to all, the Civic Center aims to manifest the city’s values, advance social justice, and demonstrate the power of true public space.”

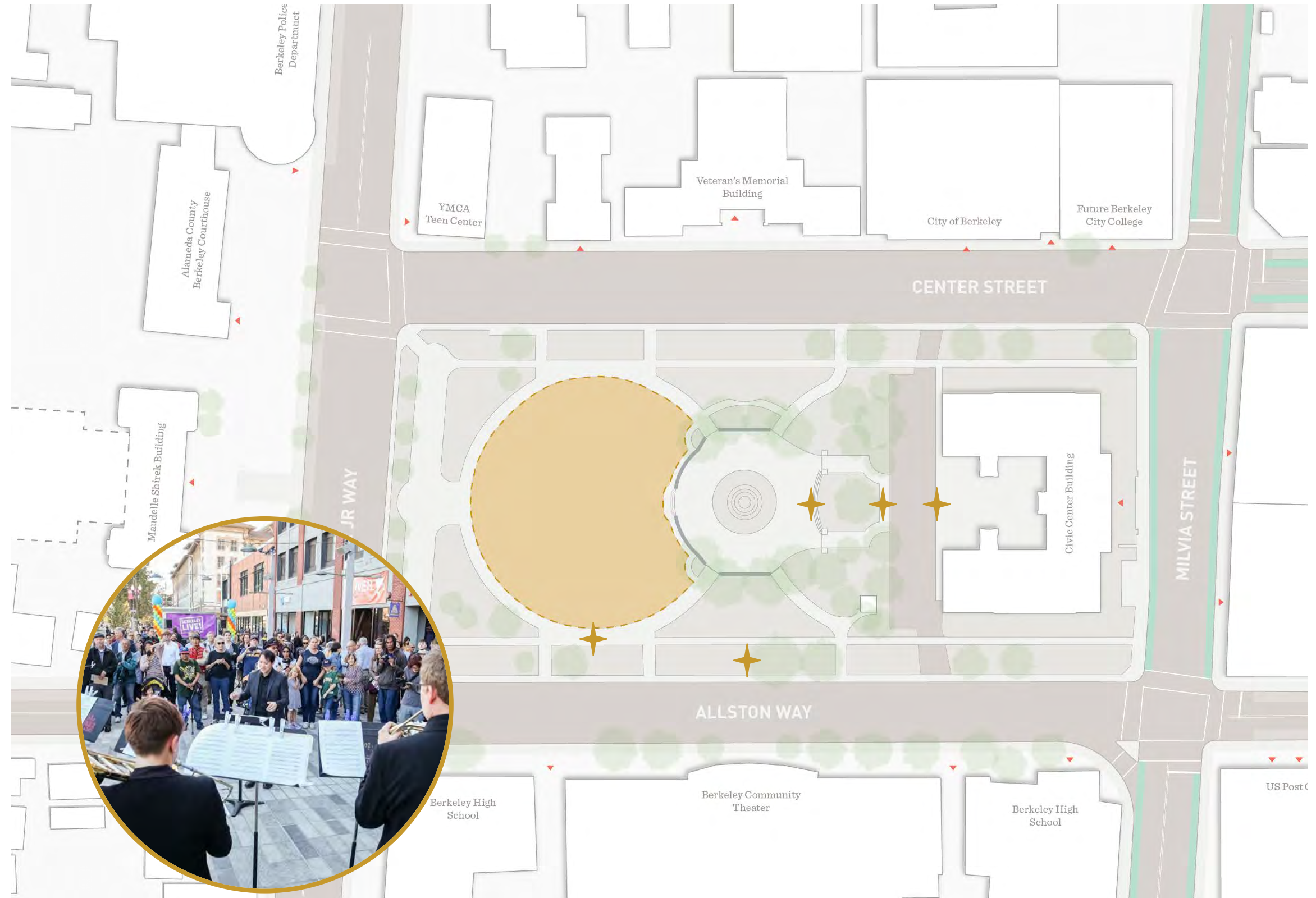

Legend

★ Outdoor stage locations

Approach 3: Convert parking lot into a useful park element

“Civic Center will be the heart of Berkeley’s community. Civic Center will be the **prime space for civic life**, culture, and the arts.

It will reflect the city’s diverse identities, celebrating its history and contributing to shaping its future.

A place of shared resources and a platform for free expression accessible to all, the Civic Center aims to manifest the city’s values, advance social justice, and demonstrate the power of true public space.”



Approach 4: Protect mature trees and enhance biodiversity

“Civic Center will be the heart of Berkeley’s community. Civic Center will be the prime space for civic life, culture, and the arts.

It will reflect the city’s diverse identities, **celebrating its history** and contributing to shaping its future.

A place of shared resources and a platform for free expression accessible to all, the Civic Center aims to **manifest the city’s values**, advance social justice, and demonstrate the power of true public space.”



Legend

- Heathy, High Value
- Unhealthy, High Value
- Heathy, Low Value
- Unhealthy, Low Value

Approach 5: Explore opportunities for potential creek daylighting (for future exploration)

“Civic Center will be the heart of Berkeley’s community. Civic Center will be the prime space for civic life, culture, and the arts.

It will reflect the city’s diverse identities, **celebrating its history** and contributing to shaping its future.

A place of shared resources and a platform for free expression accessible to all, the Civic Center aims to **manifest the city’s values**, advance social justice, and demonstrate the power of true public space.”

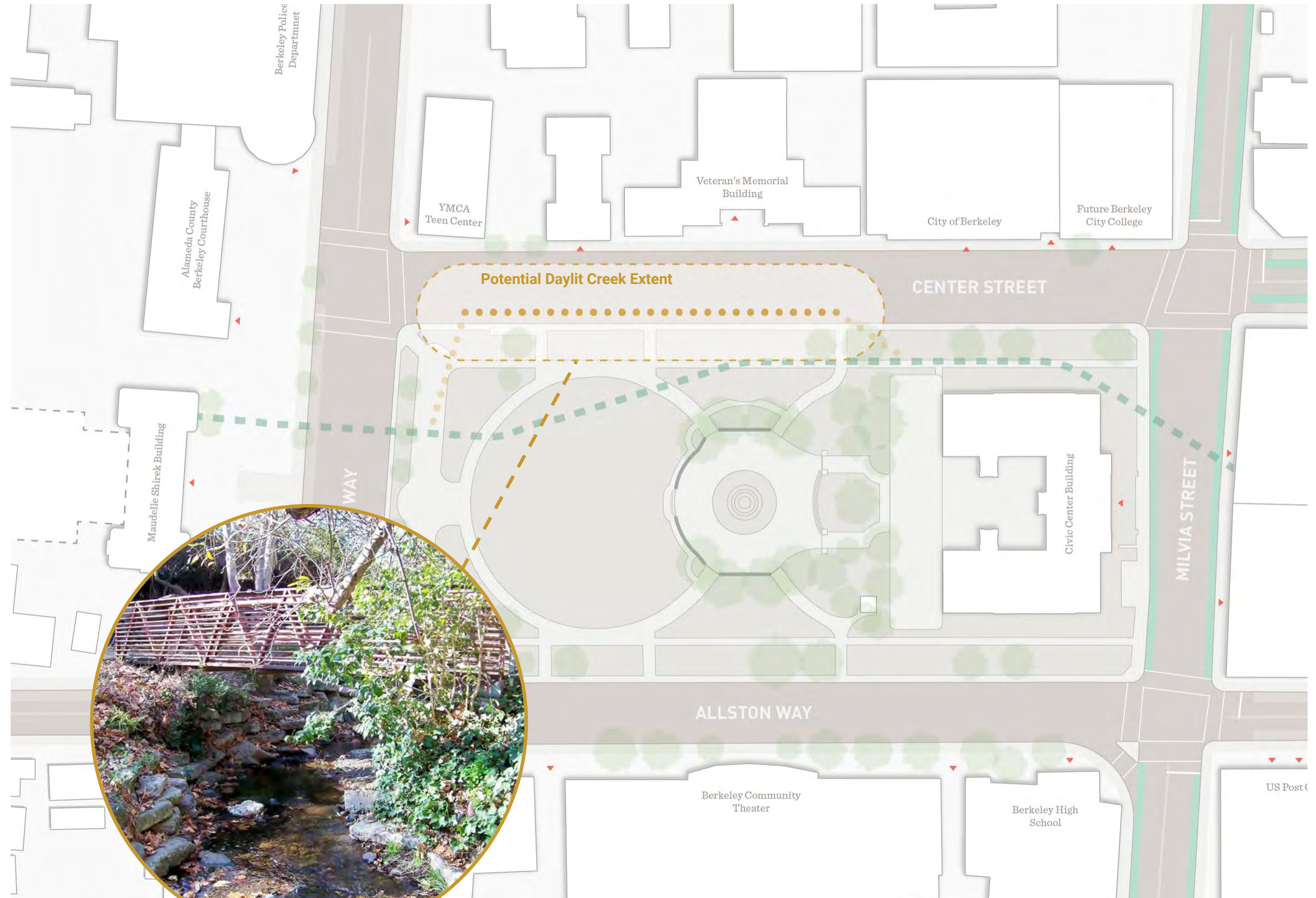

Legend

- Existing Creek Culvert
- Potential Daylit Creek**

**Daylighting feasibility will require additional study

Approach 6: Expand and upgrade play areas for all ages

“Civic Center will be the heart of Berkeley’s community. Civic Center will be the prime space for civic life, culture, and the arts.

*It will reflect the **city’s diverse identities**, celebrating its history and **contributing to shaping its future**.*

A place of shared resources and a platform for free expression accessible to all, the Civic Center aims to manifest the city’s values, advance social justice, and demonstrate the power of true public space.”



Approach 7: Modify paths to bring people to and through the park

“Civic Center will be the heart of Berkeley’s community. Civic Center will be the prime space for civic life, culture, and the arts.

*It will reflect the **city’s diverse identities**, celebrating its history and **contributing to shaping its future**.*

A place of shared resources and a platform for free expression accessible to all, the Civic Center aims to manifest the city’s values, advance social justice, and demonstrate the power of true public space.”



Approach 8: Bring food and beverage options to the park

“Civic Center will be the heart of Berkeley’s community. Civic Center will be the **prime space for civic life**, culture, and the arts.

It will reflect the **city’s diverse identities**, celebrating its history and contributing to shaping its future.

A place of shared resources and a platform for free expression accessible to all, the Civic Center aims to manifest the city’s values, advance social justice, and demonstrate the power of true public space.”



Approach 9: Introduce creative seating to invite ways of using the park

“Civic Center will be the heart of Berkeley’s community. Civic Center will be the **prime space for civic life, culture, and the arts.**

It will reflect the **city’s diverse identities, celebrating its history and contributing to shaping its future.**

A place of shared resources and a platform for free expression accessible to all, the Civic Center aims to manifest the city’s values, advance social justice, and demonstrate the power of true public space.”



Approach 10: Install seasonal or permanent art elements

*“Civic Center will be the heart of Berkeley’s community. Civic Center will be the **prime space for civic life, culture, and the arts.**”*

It will reflect the city’s diverse identities, celebrating its history and contributing to shaping its future.

A place of shared resources and a platform for free expression accessible to all, the Civic Center aims to manifest the city’s values, advance social justice, and demonstrate the power of true public space.”



Approach 11: Improve lighting to create space and add character

*“Civic Center will be the heart of Berkeley’s community. Civic Center will be the **prime space for civic life, culture, and the arts.***

It will reflect the city’s diverse identities, celebrating its history and contributing to shaping its future.

*A place of shared resources and a platform for free expression accessible to all, the Civic Center aims to manifest the city’s values, advance social justice, and demonstrate the **power of true public space.**”*



Berkeley Civic Center

Safer & Slower

Streets

Goal: Calm traffic on streets neighboring MLK Jr. Civic Center Park

“Civic Center will be the heart of Berkeley’s community. Civic Center will be the prime space for civic life, culture, and the arts.

It will reflect the city’s diverse identities, celebrating its history and contributing to shaping its future.

*A place of shared resources and a platform for free expression **accessible to all**, the Civic Center aims to manifest the city’s values, advance social justice, and demonstrate the power of true public space.”*

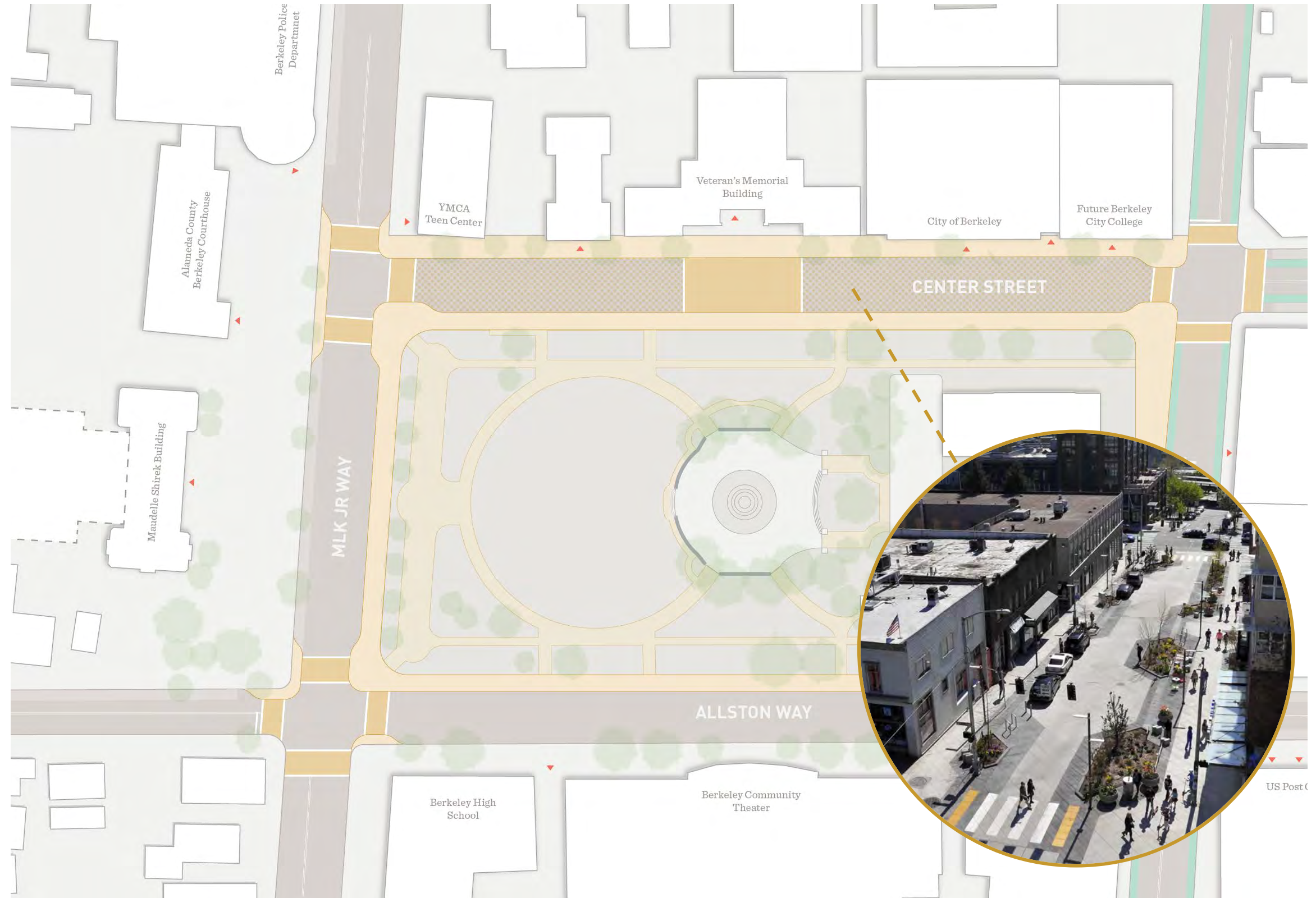

Traffic calming and safety approaches for neighboring streets

MLK Jr. Way



Introduce a road diet on MLK Jr. Way that slows cars by narrowing driving lanes and widening sidewalks to align with the adjacent blocks.



Add pedestrian bulb-outs to expand sidewalk space, shorten crossing distances, and increase pedestrian visibility and safety.

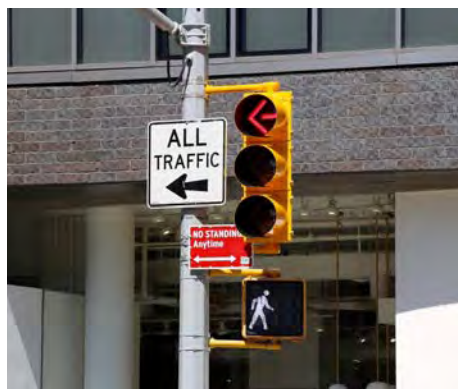

Adjust existing pedestrian signals to provide safe timing for pedestrians to cross MLK Jr. Way.

Center Street



Add **ground markings or painting** on Center Street to indicate to drivers they are entering a pedestrian priority zone.



Construct a **midblock speed table** on Center Street that raises the entire wheelbase of a vehicle to reduce its traffic speed.



Reconstruct a **curbless street** that levels sidewalks and street to create a shared surface for vehicles and pedestrians.

Allston Way



Consider a mid-block crossing to allow Berkeley High Students to safely walk to the park.



Introduce a road diet on Allston Way to widen sidewalks along the park and slow car traffic.

Berkeley Civic Center

Building Restoration

Restore Veterans Memorial Building as Community Arts Center

“Civic Center will be the heart of Berkeley’s community. Civic Center will be the **prime space for civic life, culture, and the arts.**”

It will reflect the city’s diverse identities, celebrating its history and contributing to shaping its future.

A place of shared resources and a platform for free expression accessible to all, the Civic Center aims to manifest the city’s values, advance social justice, and demonstrate the power of true public space.”

USES:

- Arts Spaces**
> Performance, Practice, Classrooms
- Support Spaces**
> Offices, Storage, etc.

SECOND FLOOR (6,400 GSF)

Practice/Small Performance Offices and Auxiliary Spaces

Small Performance or Practice Spaces

Large Performance Venue

BPON+ seismic retrofit, no buttresses

FIRST FLOOR (11,300 GSF)

Performance Hall Small Performance/Practice Offices

Improved Public Entry

BASEMENT (10,300 GSF)

Back of House Use Support Spaces

Back of House Uses

TOTAL AREA (28,000 SF)

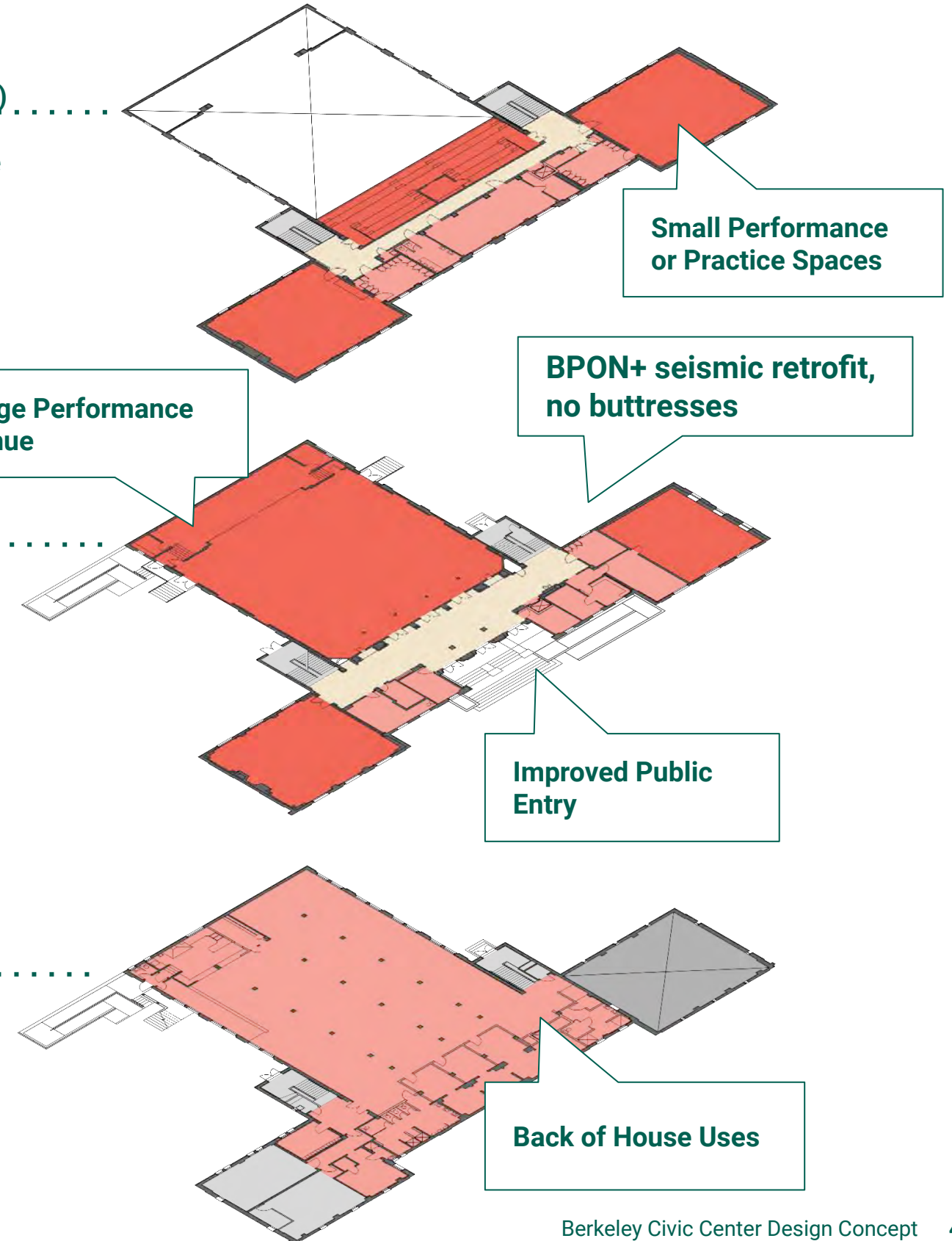

Refine space needs at Community Arts Center with arts professionals

*“Civic Center will be the heart of Berkeley’s community. Civic Center will be the **prime space for civic life, culture, and the arts.**”*

It will reflect the city’s diverse identities, celebrating its history and contributing to shaping its future.

A place of shared resources and a platform for free expression accessible to all, the Civic Center aims to manifest the city’s values, advance social justice, and demonstrate the power of true public space.”

Working with Civic Arts to assemble diverse groups of arts professionals comprised of:

- Performing and visual arts (music, dance and theater)
- Organizations that perform and produce
- Arts education groups for all ages
- Engagement and enrichment opportunities

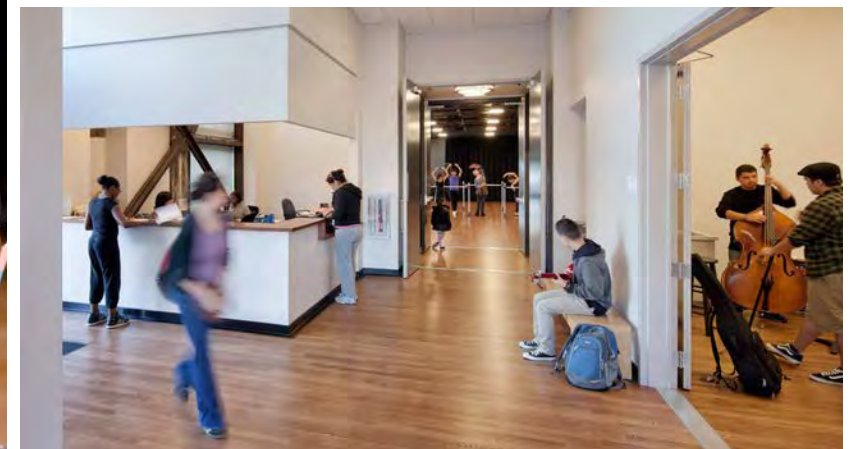

Restore Maudelle Shirek Building as a civic space

“Civic Center will be the heart of Berkeley’s community. Civic Center will be the **prime space for civic life**, culture, and the arts.

It will reflect the city’s diverse identities, **celebrating its history and contributing to shaping its future.**

A place of shared resources and a platform for free expression accessible to all, the Civic Center aims to manifest the city’s values, **advance social justice**, and demonstrate the power of true public space.”

USES:

- Council Chambers & Hearing Rooms**
 - > Public meetings rooms
- Offices (City or Vision-Aligned Organization)**
 - > Offices, meeting rooms, and support spaces.
- Berkeley Community Media**
 - > Media infrastructure & TV Studio
 - > Offices
- Berkeley Historical Society and Museum**
 - > Exhibit Spaces/Museum
 - > Office & support spaces.

SECOND FLOOR (6,500 GSF)

Small Hearing Room
Offices

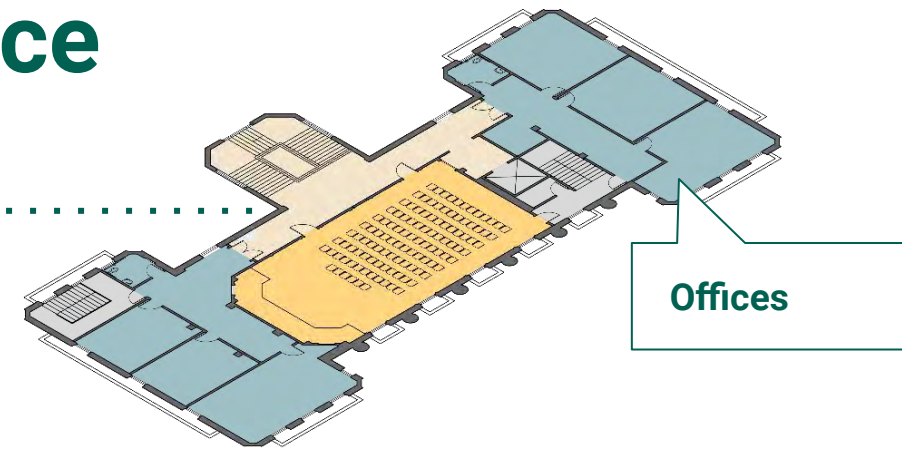

FIRST FLOOR (14,400 GSF)

Public Meeting Rooms
Large Hearing Room/Council Chambers
Offices
Berkeley Community Media

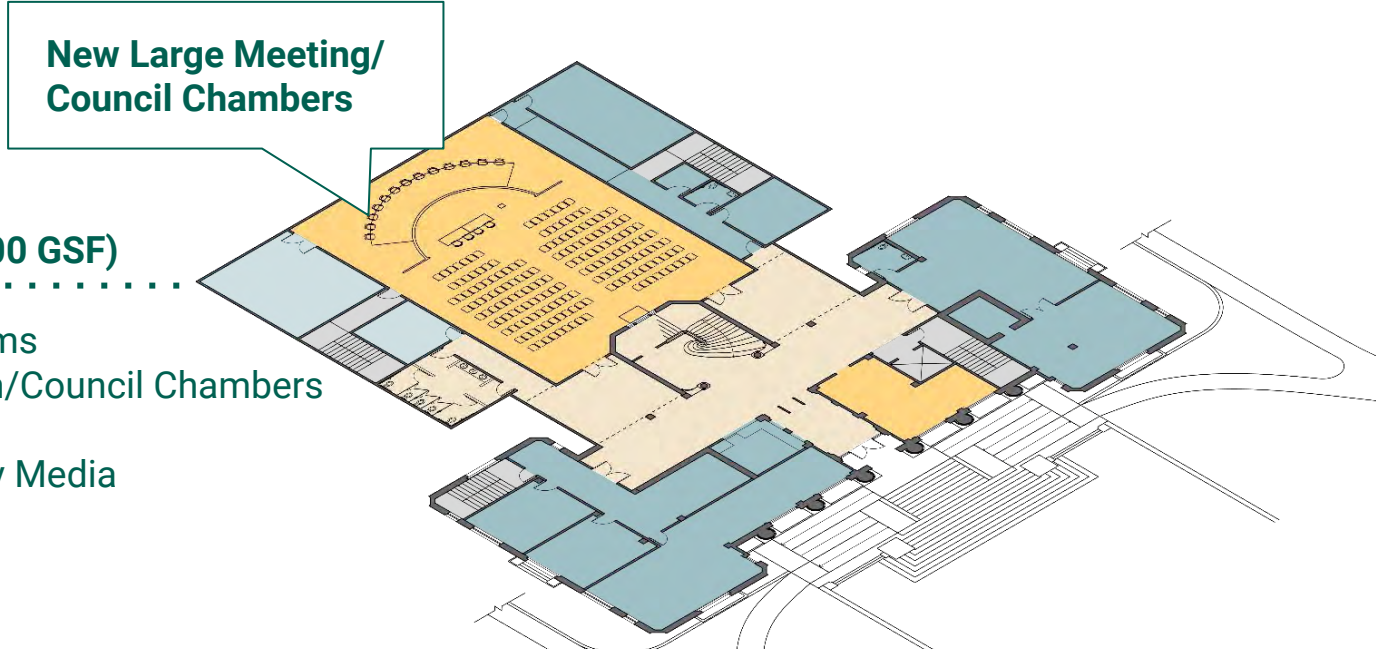

GROUND FLOOR (16,350 GSF)

Care and Shelter
Berkeley Community Media
Berkeley Historical Society & Museum

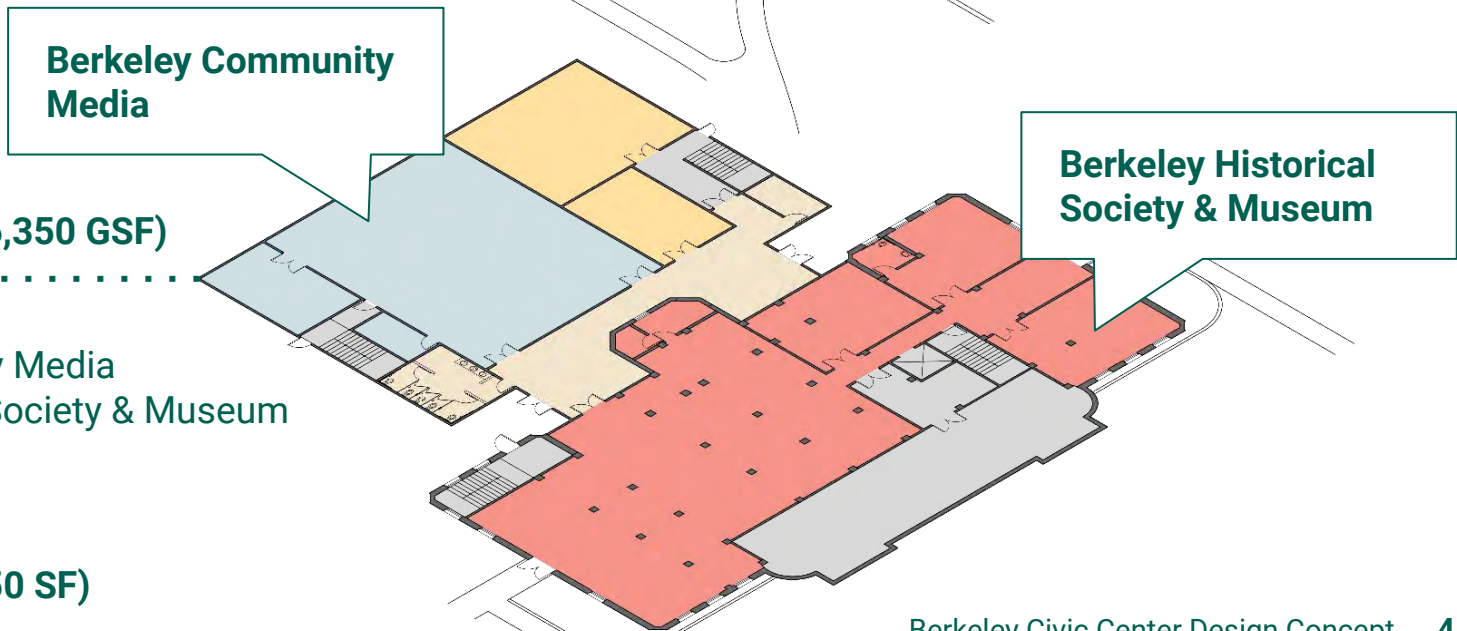

TOTAL AREA (37,250 SF)

Restore Maudelle Shirek Building as a civic space

“Civic Center will be the heart of Berkeley’s community. Civic Center will be the prime space for civic life, culture, and the arts.

It will reflect the city’s diverse identities, celebrating its history and contributing to shaping its future.

A place of shared resources and a platform for free expression accessible to all, the Civic Center aims to manifest the city’s values, advance social justice, and demonstrate the power of true public space.”

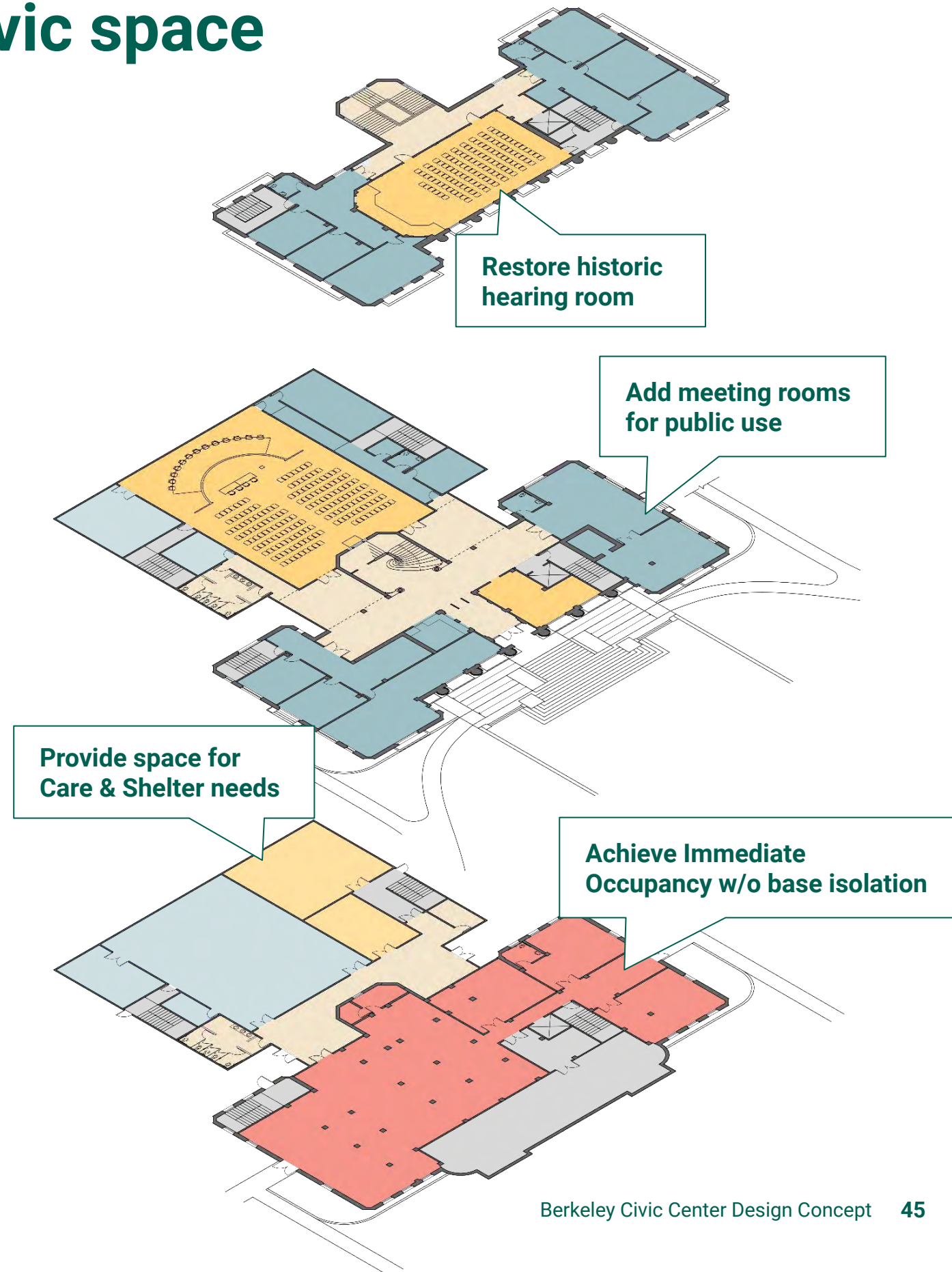

Themes

“Civic Center will be the heart of Berkeley’s **community**. Civic Center will be the prime space for **civic life, culture, and the arts**.

It will reflect the city’s **diverse identities**, celebrating its **history** and contributing to **shaping its future**.

A place of **shared resources** and a platform for **free expression** accessible to all, the Civic Center aims to manifest the city’s **values**, advance **social justice**, and demonstrate the power of **true public space**.”

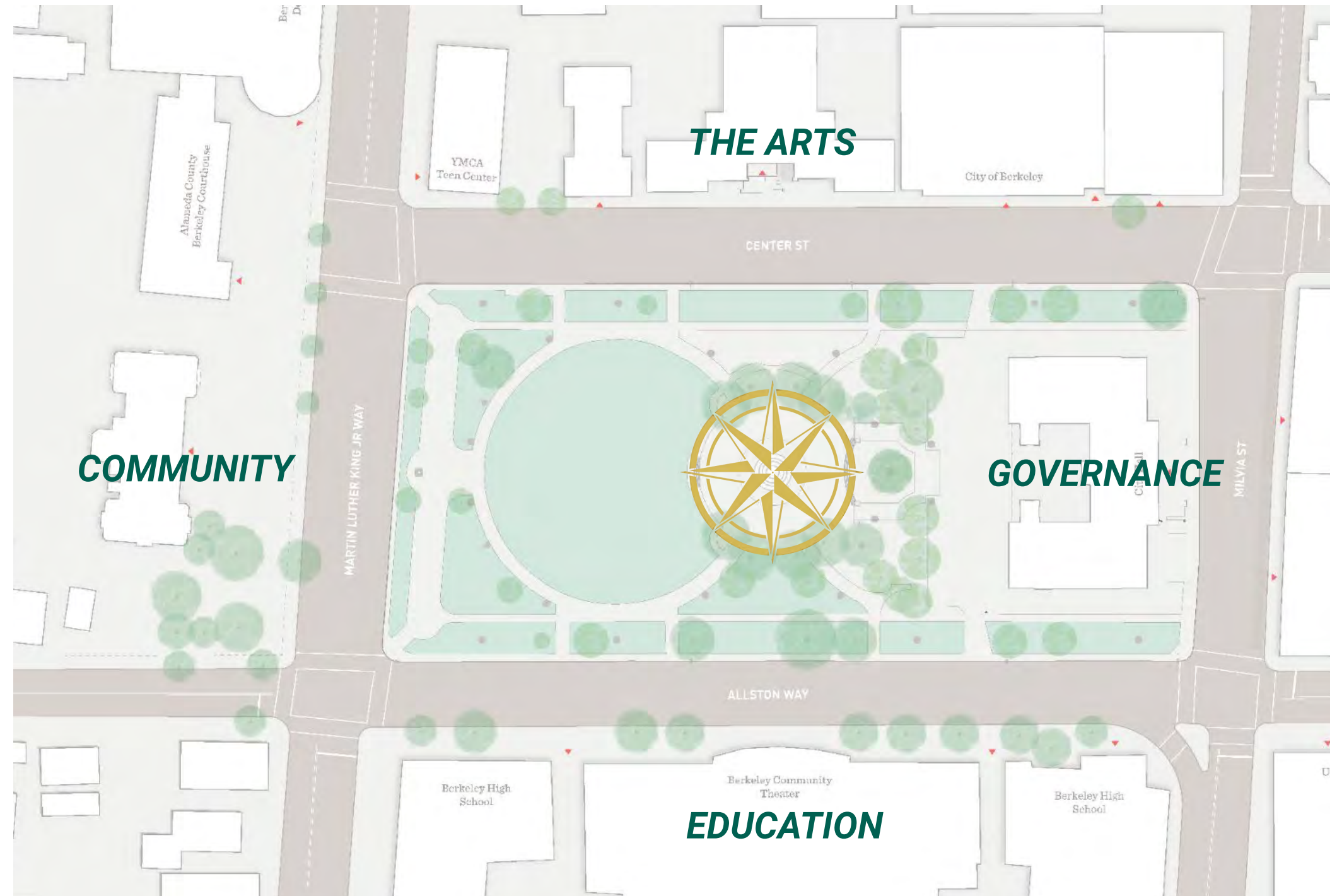

Open House Stations

Four stations:

- Maudelle Shirek Building
- Veterans Memorial
- MLK Jr Civic Center Park
- Public Realm and Streets

Station - Maudelle Shirek Building

A. What uses are you most excited about for the building?
(Pick up to four uses.)

B. How do you imagine yourself using the building in the future?

C. How do you imagine community using the building?

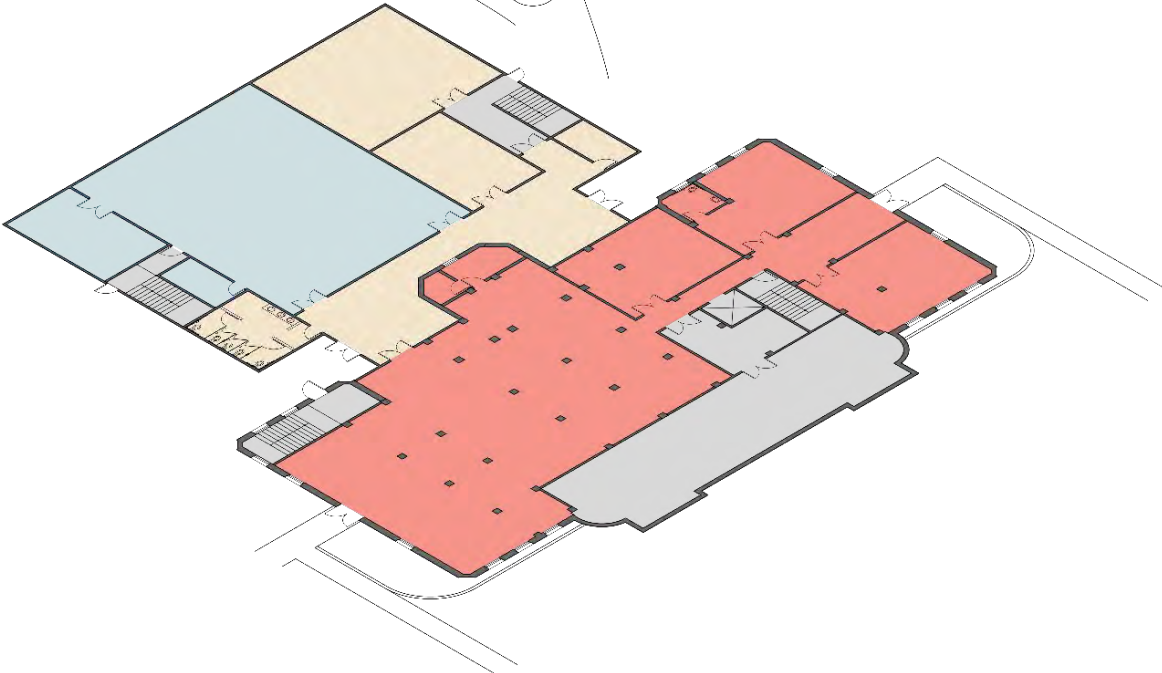
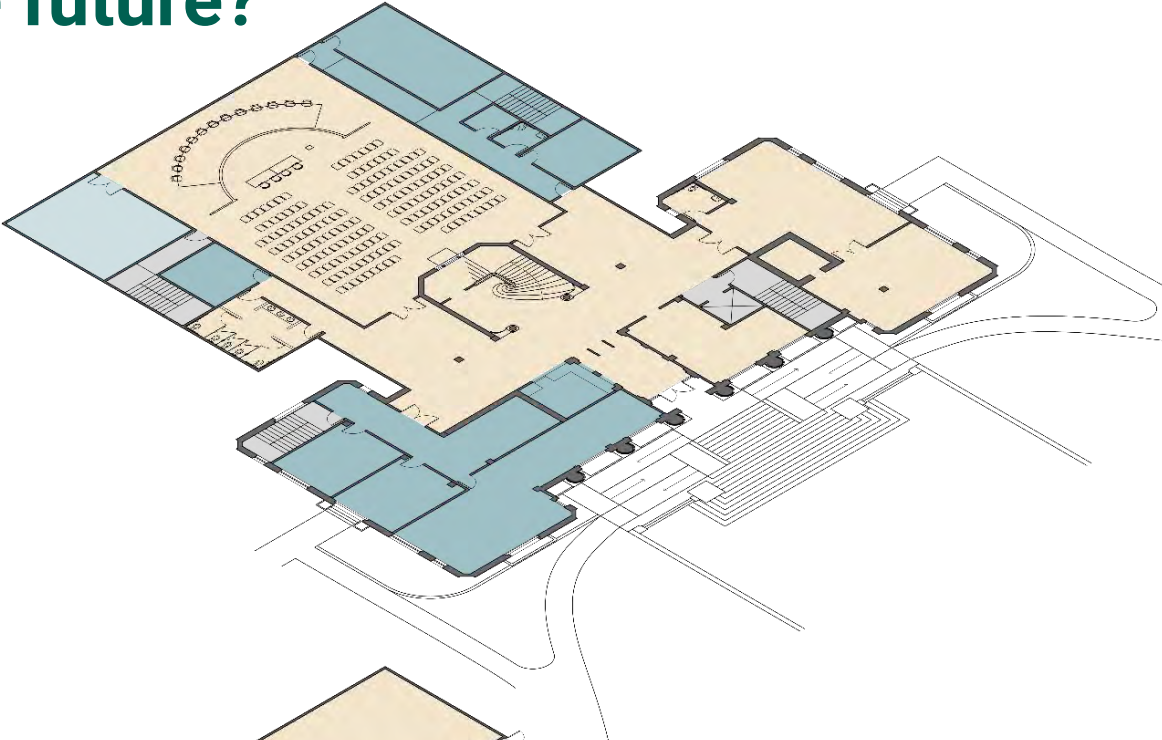
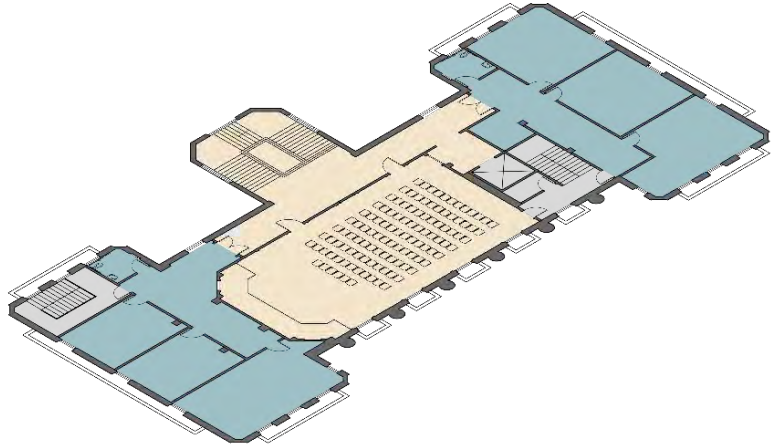

Station - Veterans Memorial Building

- A. What kinds of art programs do you think the community needs most? *(pick up to four)*

- B. What types of arts programs would bring YOU to a new Berkeley Community Arts Center?

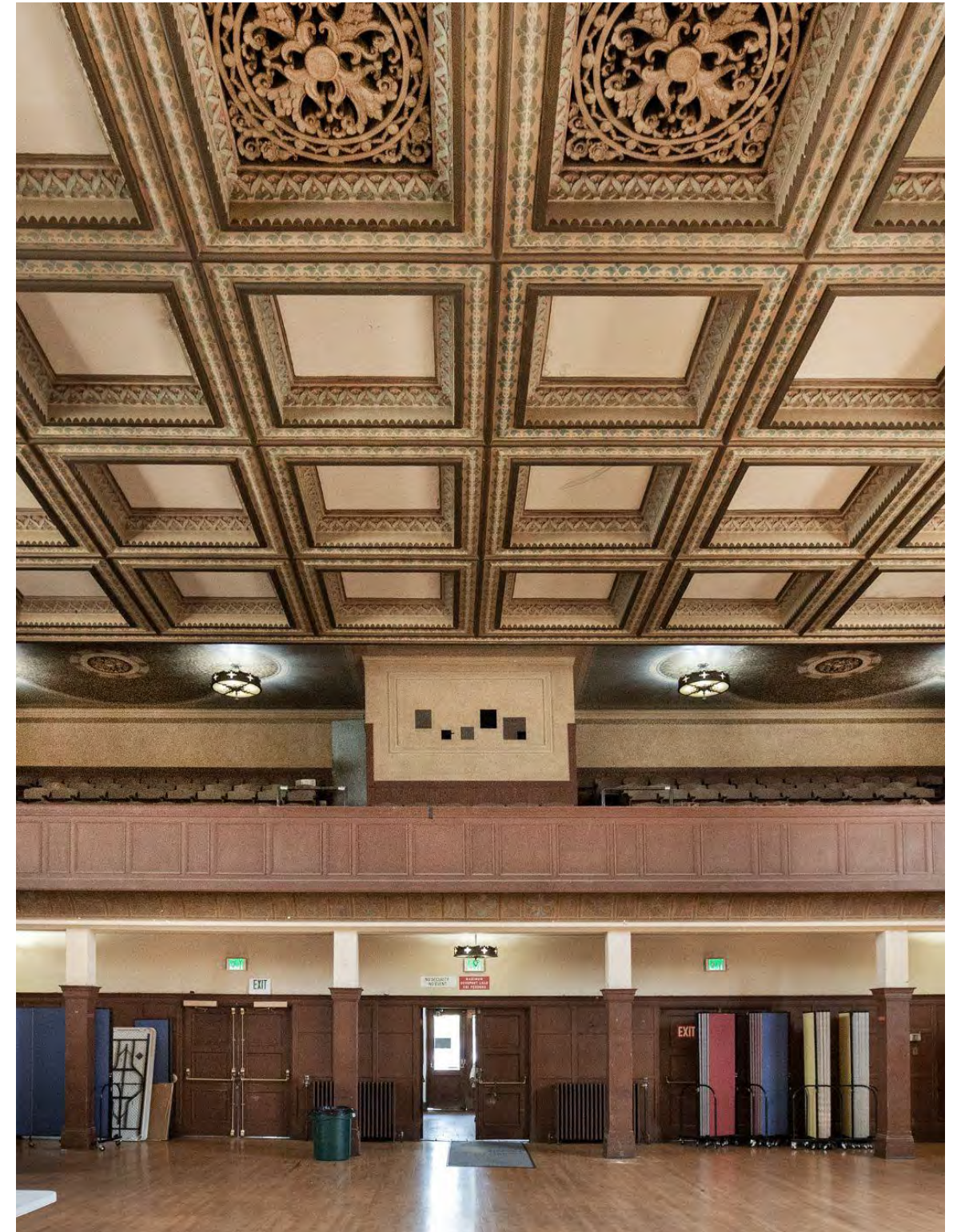

Station - MLK Jr Civic Center Park

A. What improvements would make you proud of your city and bring you to the park?
(Pick up to six)

B. In your view, what park character would best advance the vision for Civic Center? *(traditional, playful, natural)*

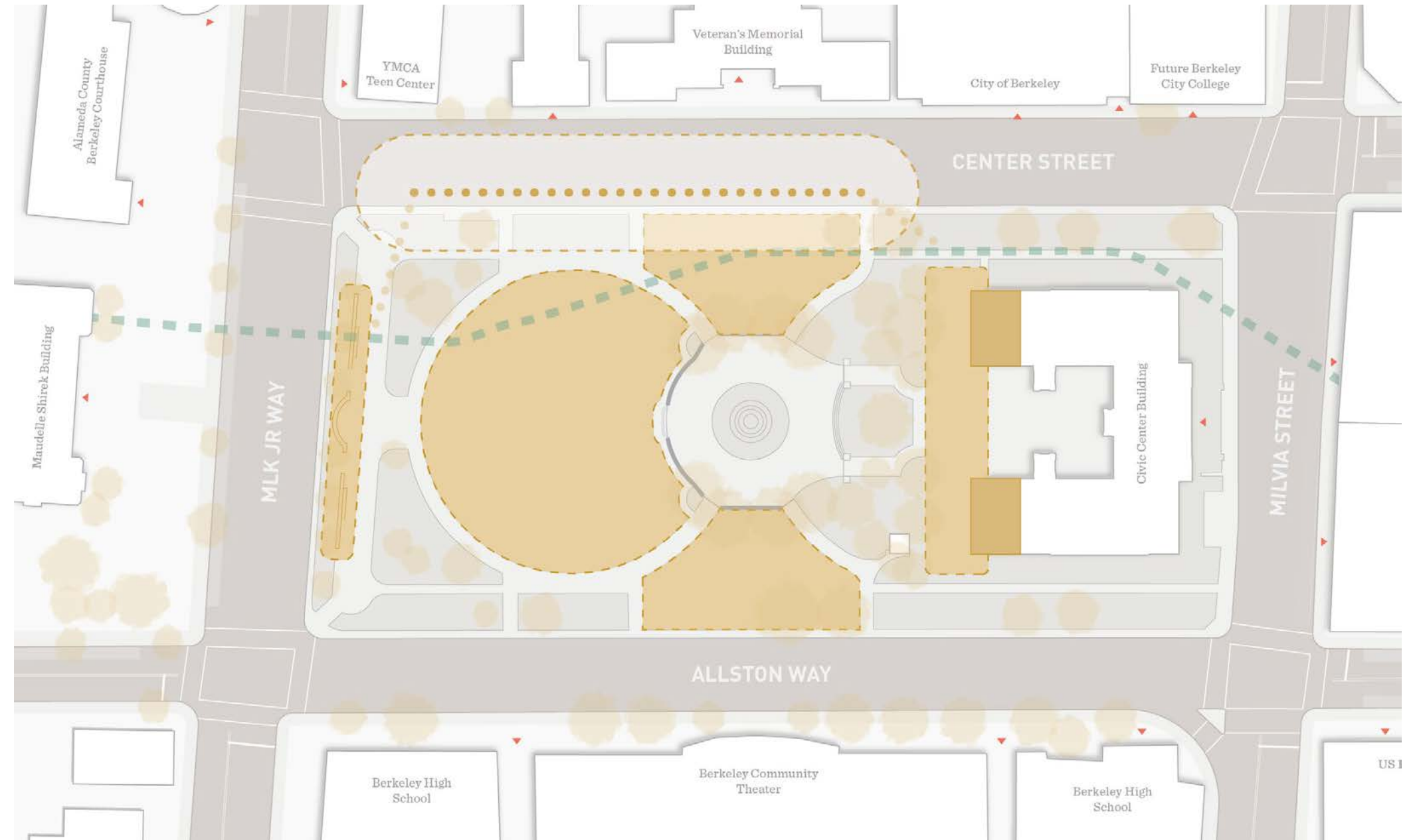

Character:

Traditional



Playful



Natural



MLK Jr. Civic Center Plan

Question:

In your view, what park character would best advance the vision for Civic Center?

(Divide the pie chart between the three options)

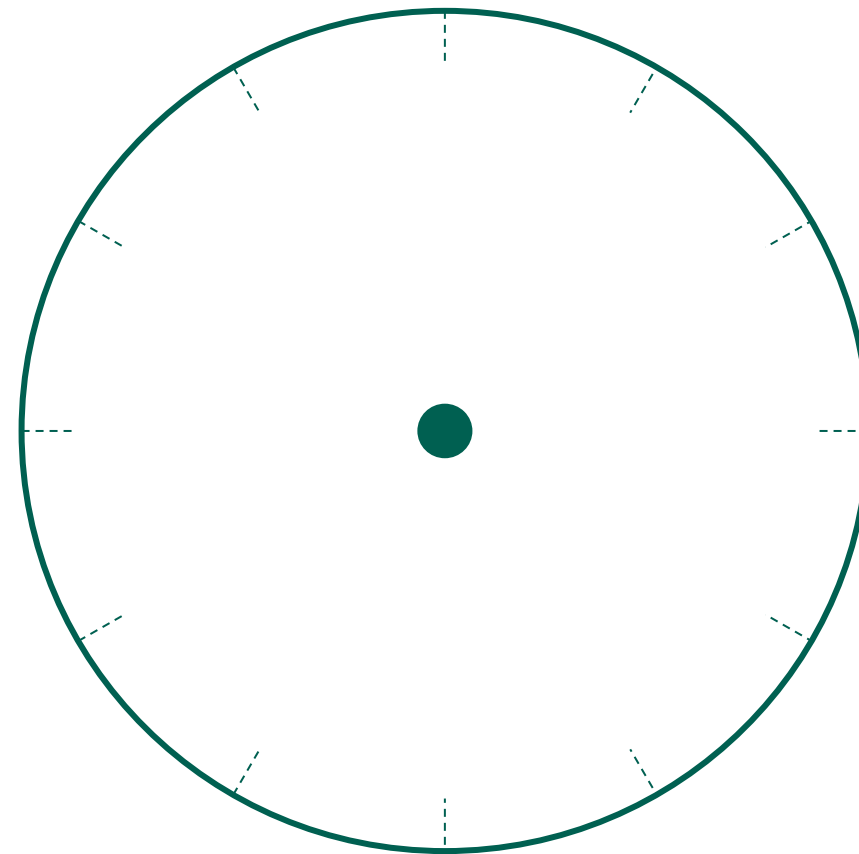

Traditional (T)
Playful (P)
Natural (N)

Example Responses:

“The park should be traditional and formal.”



“A balance of old, new and natural.”

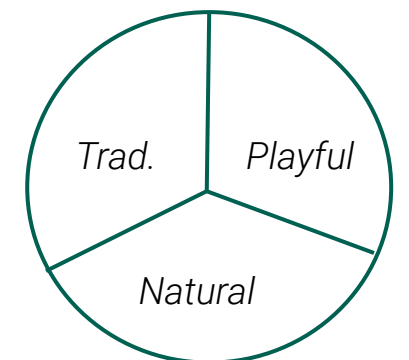

“Mostly Natural”

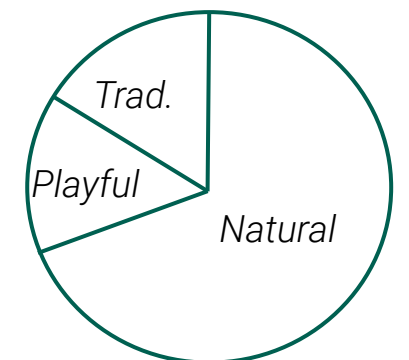

Station - Slower and Safer Streets

How do you feel about the following design approaches to improving pedestrian safety and calming traffic around Civic Center?



- A. *Changing paths in park*
- B. *Slowing MLK traffic with a street diet*
- C. *Eliminating or reducing parking on Center*
- D. *Changing paving on Center*

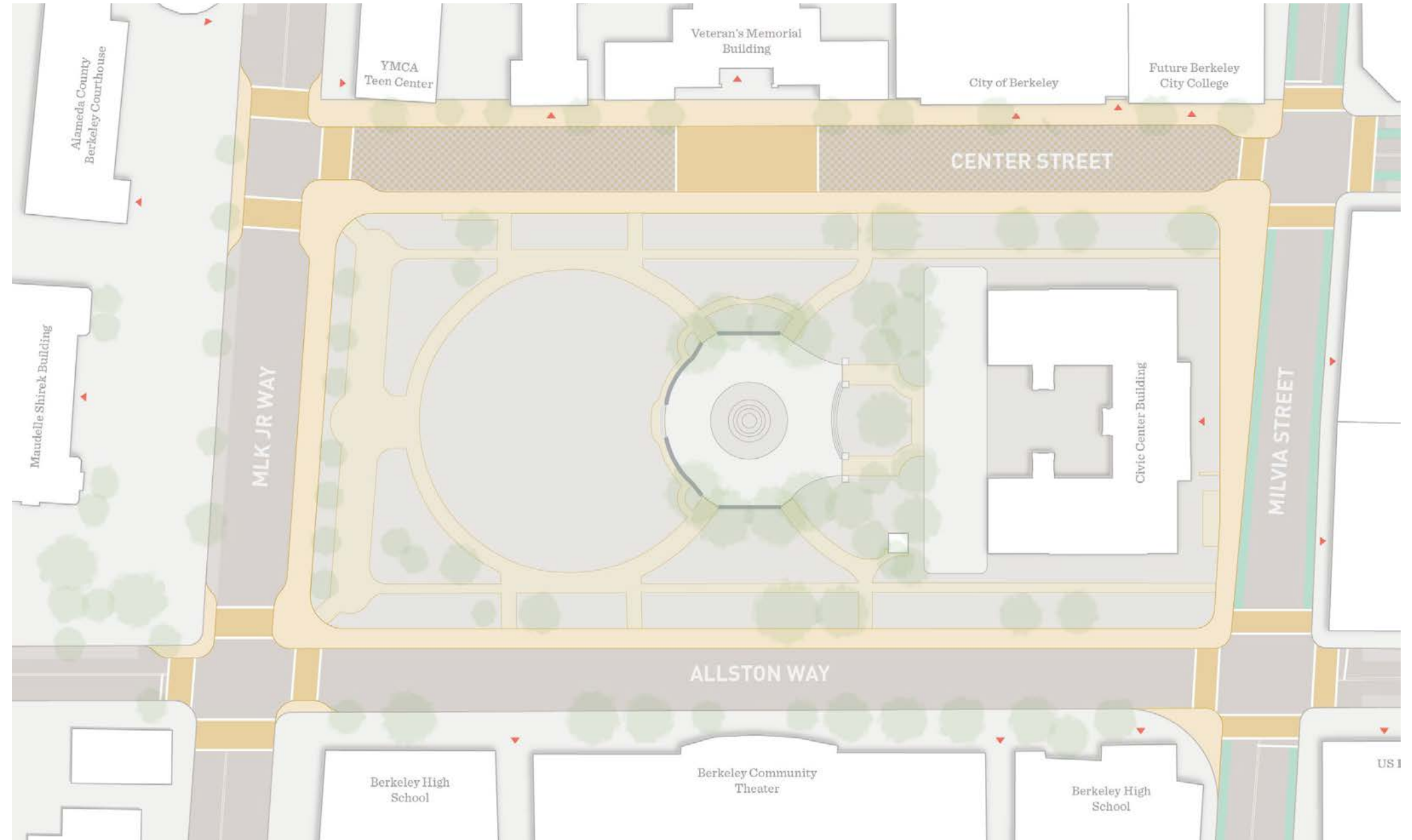

Slower and Safer Streets

Question:

In your view, what street character would best advance the vision for Civic Center?

(Divide the pie chart between the three options)

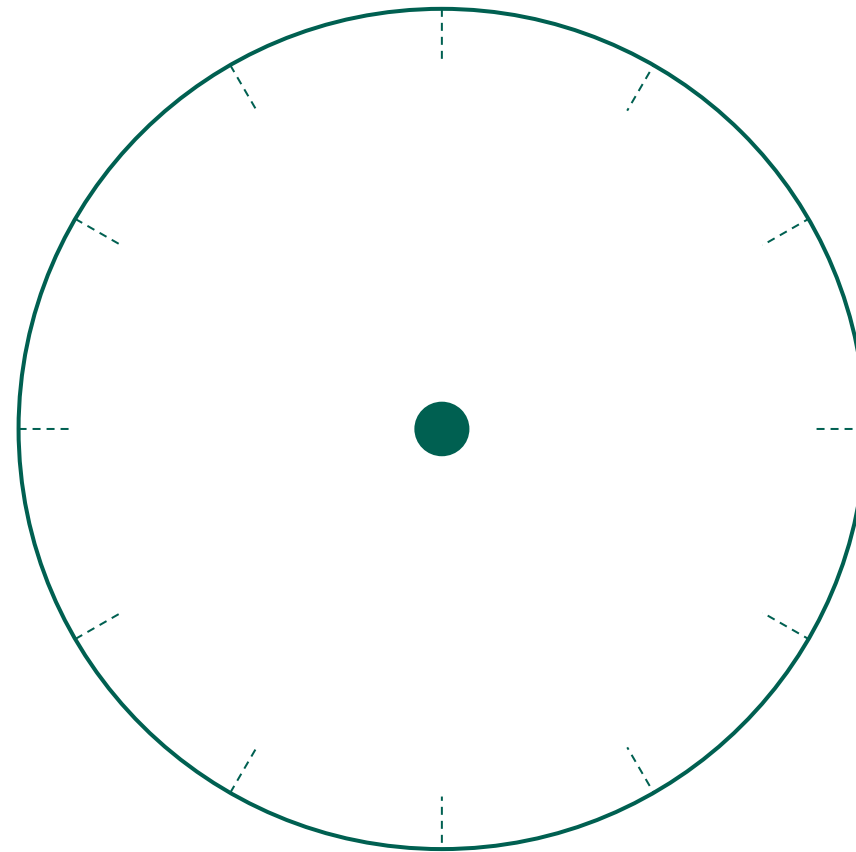

Traditional (T)
Playful (P)
Natural (N)

Example Responses:

“The streets should be like a typical street.”



“A combination of traditional, new and natural.”

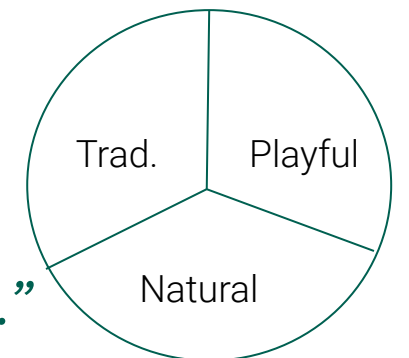

Natural and playful” - time for something new!

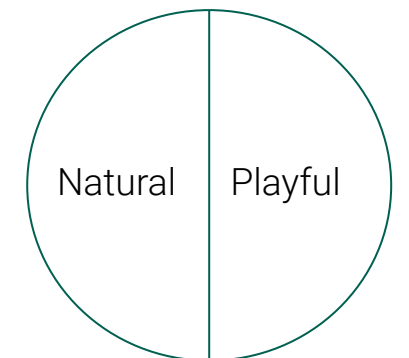

Character:

Traditional



Playful



Natural



Thank you

Contact: CivicCenter@cityofberkeley.info

SIEGEL & STRAIN Architects

Gehl ecb

