



City of Berkeley

WATERFRONT BIKE PARK

Design Options

Public Workshop # 2

September 29, 2022

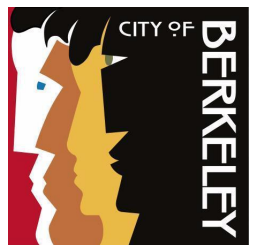

AGENDA



- Existing Site
- Design Concepts
- Preferred Riding Features
- Preferred Site Amenities
- Open Discussion
- Next Steps



EXISTING SITE

University Avenue

Approximate Bike Park Area adjacent to recently renovated University Avenue



EXISTING SITE

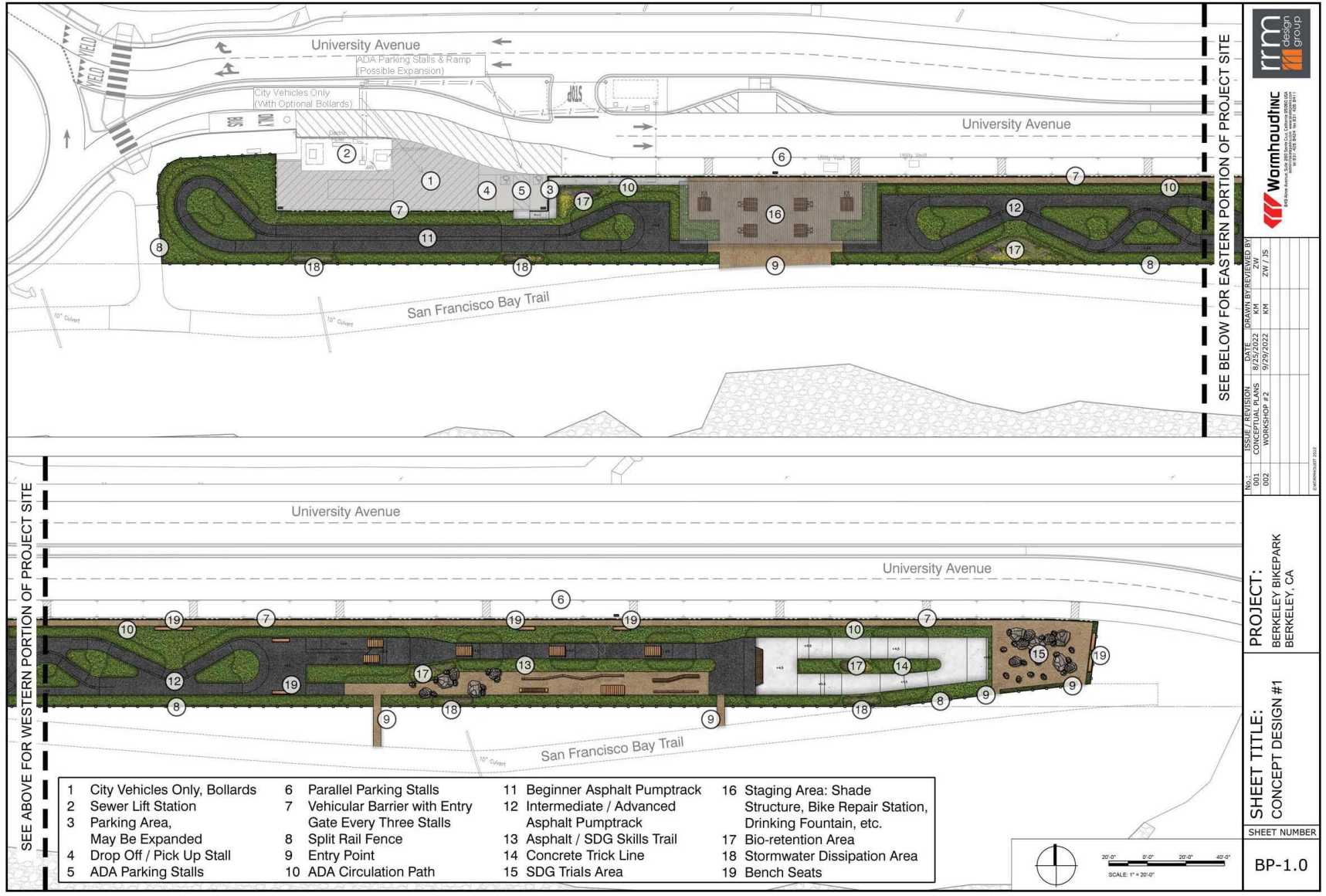

SEE ABOVE FOR WESTERN PORTION OF PROJECT SITE

SEE BELOW FOR EASTERN PORTION OF PROJECT SITE

- | | | | |
|---------------------------------|--|--|--|
| 1 City Vehicles Only, Bollards | 6 Parallel Parking Stalls | 11 Beginner Asphalt Pumptrack | 16 Staging Area: Shade Structure, Bike Repair Station, Drinking Fountain, etc. |
| 2 Sewer Lift Station | 7 Vehicular Barrier with Entry Gate Every Three Stalls | 12 Intermediate / Advanced Asphalt Pumptrack | 17 Bio-retention Area |
| 3 Parking Area, May Be Expanded | 8 Split Rail Fence | 13 Asphalt / SDG Skills Trail | 18 Stormwater Dissipation Area |
| 4 Drop Off / Pick Up Stall | 9 Entry Point | 14 Concrete Trick Line | 19 Bench Seats |
| 5 ADA Parking Stalls | 10 ADA Circulation Path | 15 SDG Trials Area | |



rm design group

WarmhoudInc
 488 Bay Area Blvd, Suite 200, Berkeley, CA 94704
 415.851.4242 | www.warmhoud.com

ISSUE / REVISIONS	DATE	DRAWN BY	REVIEWED BY
001	8/2/2022	KK	ZW / JS
002	9/29/2022	KK	
WORKSHOP #2			

PROJECT:
 BERKELEY BIKEPARK
 BERKELEY, CA

SHEET TITLE:
 CONCEPT DESIGN #1

SHEET NUMBER
 BP-1.0

CONCEPT DESIGN #1

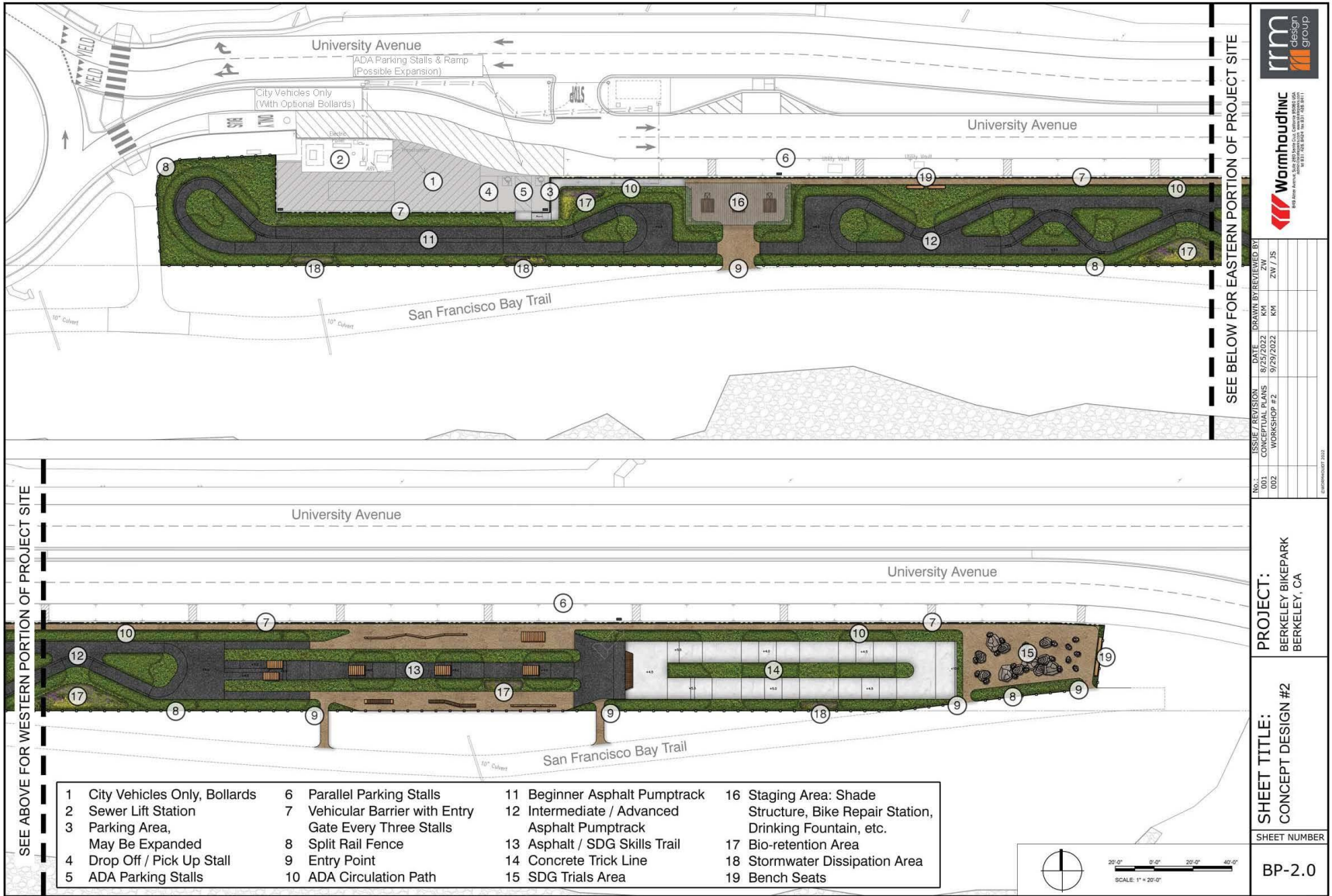

SEE ABOVE FOR WESTERN PORTION OF PROJECT SITE

SEE BELOW FOR EASTERN PORTION OF PROJECT SITE

- | | | | |
|---------------------------------|--|--|--|
| 1 City Vehicles Only, Bollards | 6 Parallel Parking Stalls | 11 Beginner Asphalt Pumptrack | 16 Staging Area: Shade Structure, Bike Repair Station, Drinking Fountain, etc. |
| 2 Sewer Lift Station | 7 Vehicular Barrier with Entry Gate Every Three Stalls | 12 Intermediate / Advanced Asphalt Pumptrack | 17 Bio-retention Area |
| 3 Parking Area, May Be Expanded | 8 Split Rail Fence | 13 Asphalt / SDG Skills Trail | 18 Stormwater Dissipation Area |
| 4 Drop Off / Pick Up Stall | 9 Entry Point | 14 Concrete Trick Line | 19 Bench Seats |
| 5 ADA Parking Stalls | 10 ADA Circulation Path | 15 SDG Trials Area | |

rm design group

Wormhouding

1000 University Avenue, Suite 200, Berkeley, CA 94704
 Phone: 415.863.8844 Fax: 415.863.8811

NO.	ISSUE / REVISION	DATE	DRAWN BY	REVIEWED BY
001	CONCEPT PLANS	9/29/2022	ZM	KM
002	WORKSHOP 2/E		ZM	KM

September 2022

PROJECT:
 BERKELEY BIKEPARK
 BERKELEY, CA

SHEET TITLE:
 CONCEPT DESIGN #2

SHEET NUMBER
 BP-2.0

CONCEPT DESIGN #2



Paved Pump Track

PREFERRED RIDING FEATURES - EXAMPLES



Skills Trail Built Features



Free Ride and Dirt Jump Style Features (Asphalt /SDG Skills Trail)

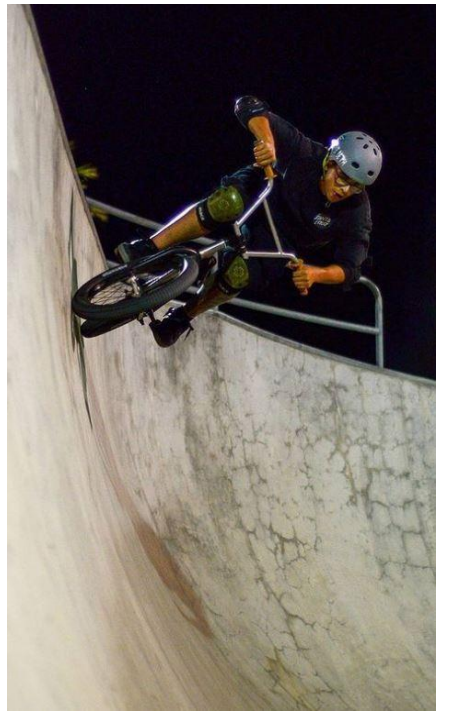
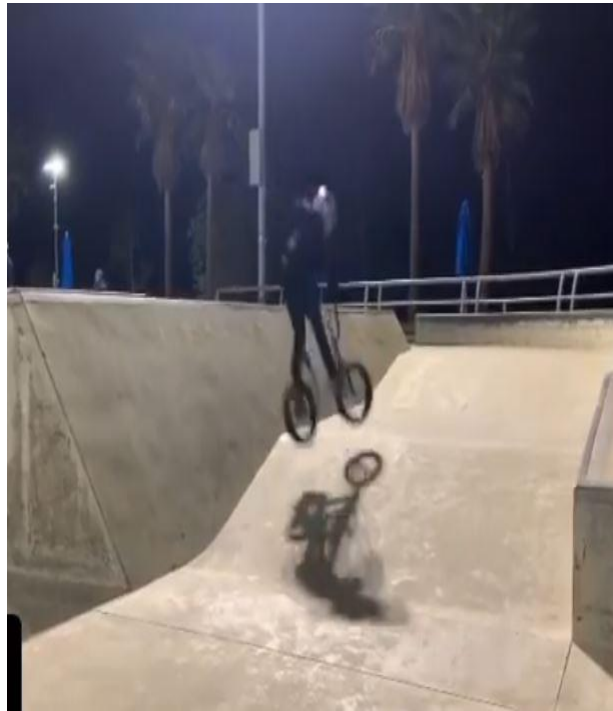

Concrete Trick Line



Trials Course



Picnic Tables



Bench Seats



Drinking Fountain



Bike Racks



Bike Repair Station





Decompose Granite (stabilized) pathways



Bioretention Swales



Vehicular Guard Rails and Gates (between University Ave and Bike Park)



**PARK AMENITIES – PRECEDENT IMAGES –
PLANTING, PATHS & GUARD RAILS**

OPEN DISCUSSION

- Which concept do you prefer and why?
- What elements do you prefer and why?
- What suggestions do you have for the final concept design?
- Any other feedback?

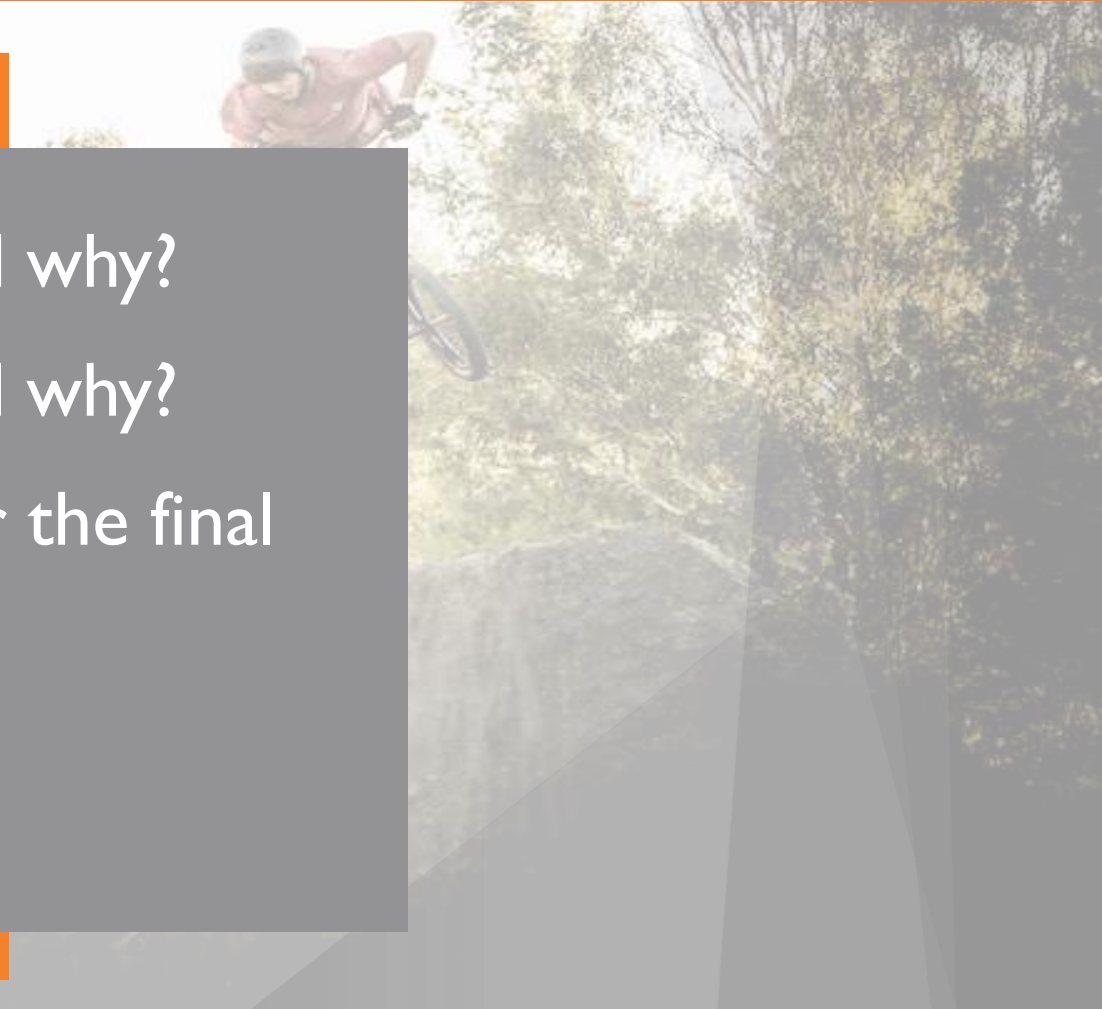



#1

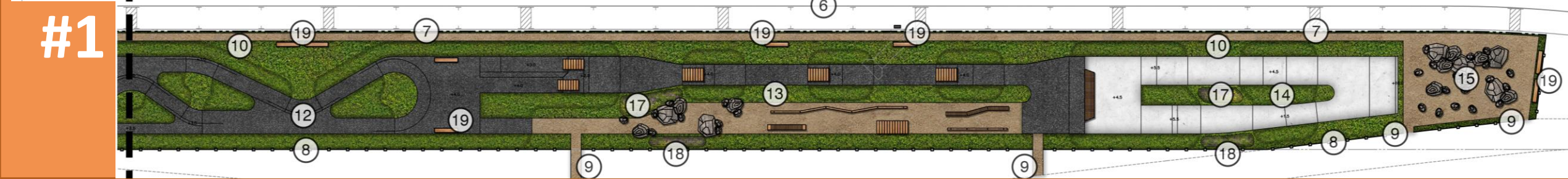

#1

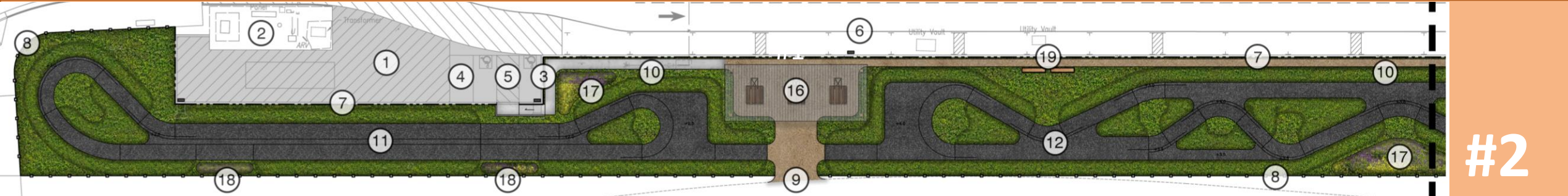

#2



#2

COMPARISON

- | | | | |
|---------------------------------|--|--|--|
| 1 City Vehicles Only, Bollards | 6 Parallel Parking Stalls | 11 Beginner Asphalt Pumptrack | 16 Staging Area: Shade Structure, Bike Repair Station, Drinking Fountain, etc. |
| 2 Sewer Lift Station | 7 Vehicular Barrier with Entry Gate Every Three Stalls | 12 Intermediate / Advanced Asphalt Pumptrack | 17 Bio-retention Area |
| 3 Parking Area, May Be Expanded | 8 Split Rail Fence | 13 Asphalt / SDG Skills Trail | 18 Stormwater Dissipation Area |
| 4 Drop Off / Pick Up Stall | 9 Entry Point | 14 Concrete Trick Line | 19 Bench Seats |
| 5 ADA Parking Stalls | 10 ADA Circulation Path | 15 SDG Trials Area | |

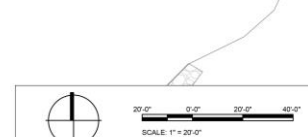

NEXT STEPS

- Survey, Interest Form, Community Workshop #1 – Spring 2022
- Community Workshop #2 – Tonight
- Prepare Supporting Documents: Drawings / Specifications and Costing
- Community Workshop #3– Present Preferred Concept – November 2022



THANK YOU FOR SHARING YOUR INPUT FOR THE WATERFRONT BIKE PARK CONCEPTUAL DESIGN PROJECT

- **Additional Questions & Comments:**
aendress@cityofberkeley.info
- **Project Interest Form:**
www.tinyurl.com/BikeParkInterestForm
- **Additional Project Information**
<https://berkeleyca.gov/your-government/our-work/capital-projects/berkeley-waterfront-bike-park-conceptual-design-project>

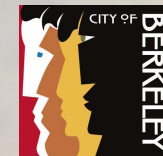

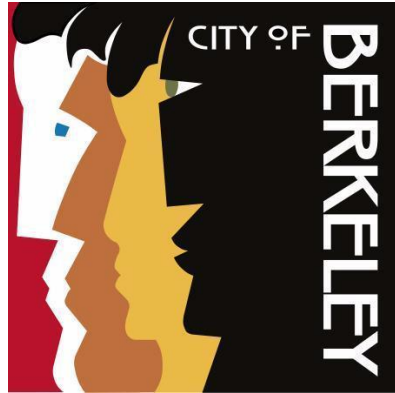



PARK AMENITIES – PRECEDENT IMAGES – SHADE STRUCTURES