

AQUATIC PARK | BOLIVAR DRIVE IMPROVEMENTS

600 ADDISON ST, BERKELEY, CA 94710

LANE PARTNERS, LLC
644 Menlo Avenue, 2nd Floor
Menlo Park, CA 94025
Tel 650.638.0100

LB2 PARTNERS
Tel 415.845.7500

Gensler

2101 Webster Street
Suite 2000
Oakland, CA 94612
United States

Tel 510.625.7400
Fax 510.625.7499



255 Shoreline Drive
Suite 200
Redwood City, CA 94065
United States

Tel 650.482.6300

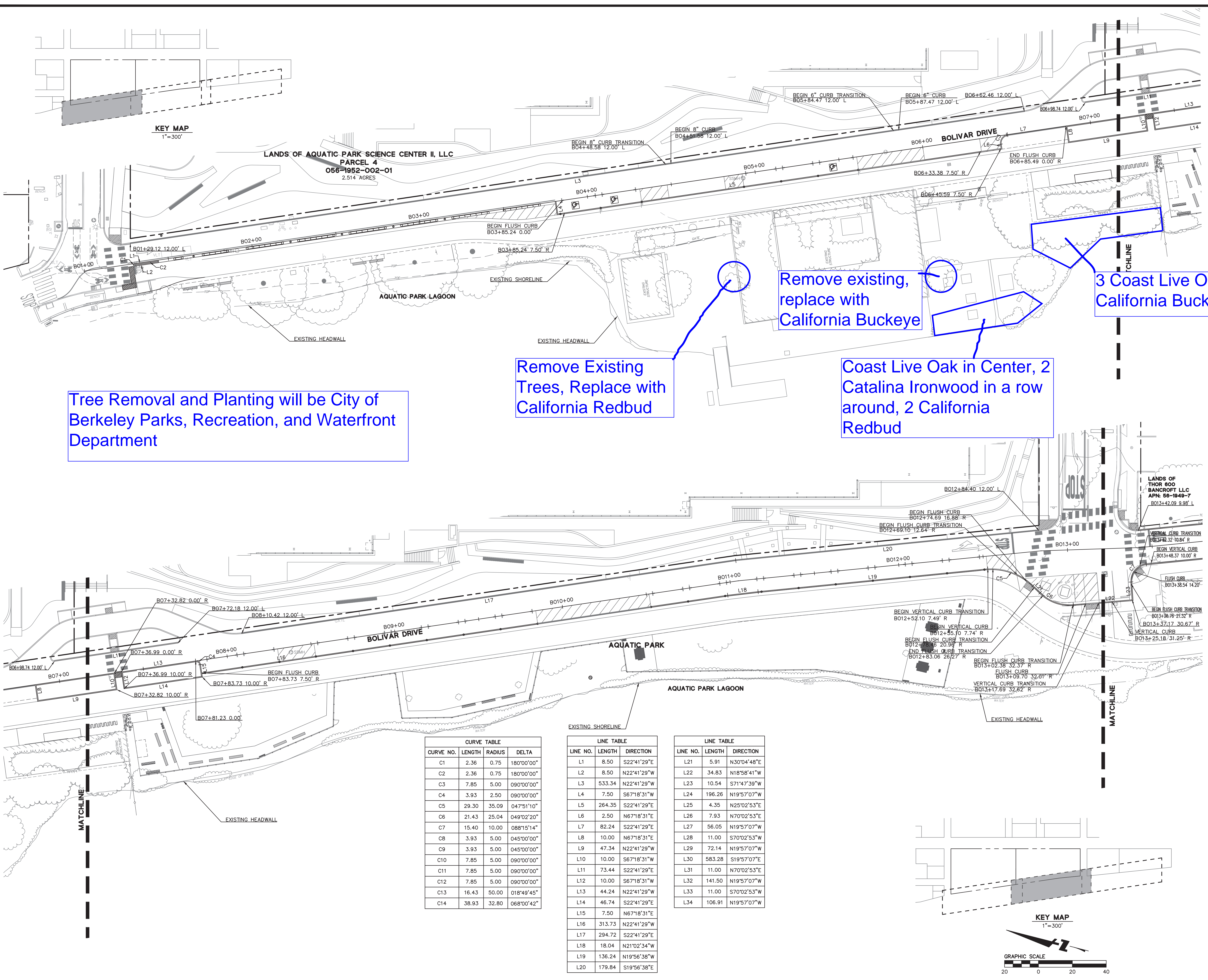

Tree Removal and Planting will be City of Berkeley Parks, Recreation, and Waterfront Department

Remove Existing Trees, Replace with California Redbud

Remove existing, replace with California Buckeye

Coast Live Oak in Center, 2 Catalina Ironwood in a row around, 2 California Redbud

3 Coast Live Oak, 4 California Buckeye

Date	Description
05.06.2022	30% SUBMISSION
10.21.2022	60% SUBMISSION
03.14.2023	90% SUBMISSION
05.01.2023	100% SUBMISSION

LANDS OF THOR 600 BANCROFT LLC APN: 55-1949-7 B013+42.09 9.98' L

CURVE NO.	LENGTH	RADIUS	DELTA
C1	2.36	0.75	180°00'00"
C2	2.36	0.75	180°00'00"
C3	7.85	5.00	090°00'00"
C4	3.93	2.50	090°00'00"
C5	29.30	35.09	047°51'10"
C6	21.43	25.04	049°02'20"
C7	15.40	10.00	088°15'14"
C8	3.93	5.00	045°00'00"
C9	3.93	5.00	045°00'00"
C10	7.85	5.00	090°00'00"
C11	7.85	5.00	090°00'00"
C12	7.85	5.00	090°00'00"
C13	16.43	50.00	018°49'45"
C14	38.93	32.80	068°00'42"

LINE NO.	LENGTH	DIRECTION
L1	8.50	S22°41'29"E
L2	8.50	N22°41'29"W
L3	533.34	N22°41'29"W
L4	7.50	S67°18'31"W
L5	264.35	S22°41'29"E
L6	2.50	N67°18'31"E
L7	82.24	S22°41'29"E
L8	10.00	N67°18'31"E
L9	47.34	N22°41'29"W
L10	10.00	S67°18'31"W
L11	73.44	S22°41'29"E
L12	10.00	S67°18'31"W
L13	44.24	N22°41'29"W
L14	46.74	S22°41'29"E
L15	7.50	N67°18'31"E
L16	313.73	N22°41'29"W
L17	294.72	S22°41'29"E
L18	18.04	N21°02'34"W
L19	136.24	N19°56'38"W
L20	179.84	S19°56'38"E

LINE NO.	LENGTH	DIRECTION
L21	5.91	N30°04'48"E
L22	34.83	N18°58'41"W
L23	10.54	S71°47'39"W
L24	196.26	N19°57'07"W
L25	4.35	N25°02'53"E
L26	7.93	N70°02'53"E
L27	56.05	N19°57'07"W
L28	11.00	S70°02'53"W
L29	72.14	N19°57'07"W
L30	583.28	S19°57'07"E
L31	11.00	N70°02'53"E
L32	141.50	N19°57'07"W
L33	11.00	S70°02'53"W
L34	106.91	N19°57'07"W



Seal / Signature
NOT FOR CONSTRUCTION

Project Name
BERKELEY COMMONS

Project Number
33.4462.000

Description
HORIZONTAL CONTROL PLAN

Scale
1" = 20'

C4.2