



**REDESIGN OF  
ADELINE STREET AT ASHBY BART**  
for access for all users and a new community plaza space

**City Council Presentation**

November 29, 2022



# Project Context

November 29, 2022

## Plans and Policies

- City Council Referral (2020)
- Adeline Corridor Specific Plan (2020)
- Pedestrian Plan (2021)

## Refined Design/Implementation Projects:

- N. Adeline Quick-Build Project (2020)
- S. Adeline Street Improvements (late 2022 – 2024)
- **Adeline Street at Ashby BART Redesign (2022)**

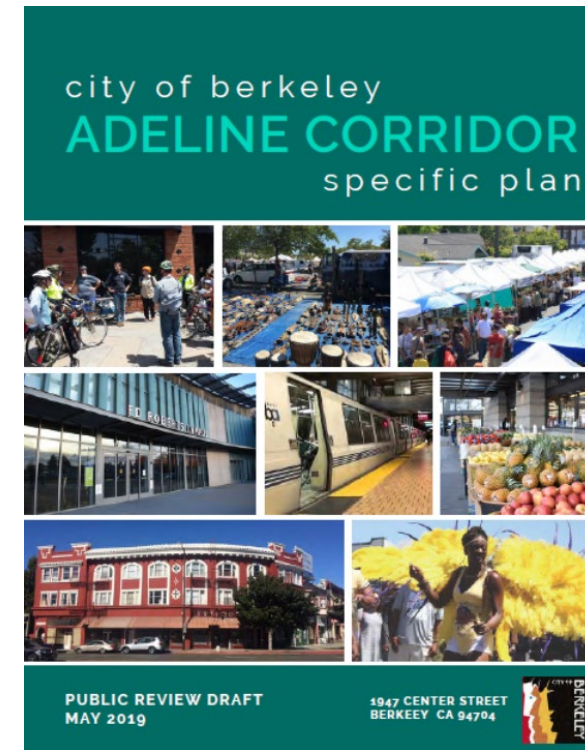

Adeline Street Roadway Redesign Concept

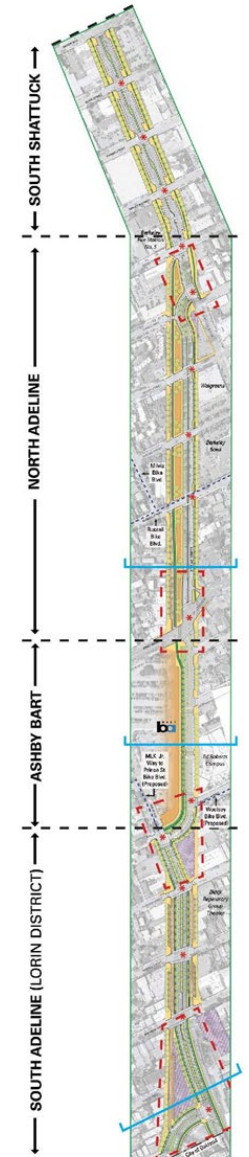

# Where we are in the process

November 29, 2022

● 2022

## Fall Adeline & Plaza Options

- Sept. – Vendor and Other Stakeholder Outreach
- 10/3 – Community Meeting
- 10/20 – Transportation and Infrastructure Commission
- **11/29 – City Council Meeting**

● 2023

## Winter

BART Community Meeting: discuss connections between plaza and future development

## Spring

City Council & BART Board of Directors: finalize Ashby Related Memorandum of Agreement (MOA)

## Spring to Fall

Developer(s) selection process

● 2024

Ashby BART Objective Design Standards developed and adopted

● 2025

Development Project application and entitlements

● 2026 and beyond

- Phased financing/ construction and Berkeley Flea Market move to temporary location sequencing to be determined
- Berkeley Flea Market moves to permanent location

Pursue funding for further design of Adeline Street and the plaza

## Berkeley Flea Market

- City and BART staff met with Board several times January through August
- Meetings with Vendors
  - Open House at the Flea Market 9/17
  - Vendor Meeting 9/28

## Other Stakeholder Meetings

- Ed Roberts Campus Board Members
- Ecology Center
- Lorin Business Association

## Community Meetings

- Two meetings in October
  - Community Meeting 10/3
  - Office Hours 10/6



## Transportation and Infrastructure Commission

- 10/20 Public Comment

## Ashby BART Station

- Station Access needs
- Operations needs
- Accessibility

## Flea Market

- Maximize vendor space
- Provide new amenities

## Realign Adeline/MLK Intersection

- Additional public space
- Possible additional Flea Market space

## Future Development

- Maximize affordable housing
  - Avoid displacement
- New public open space

## Adeline Street Redesign

- Safe access for everyone
- Meet the needs of public transit
  - More community space

## Other Community Input

- South Berkeley Community
- Broader Community

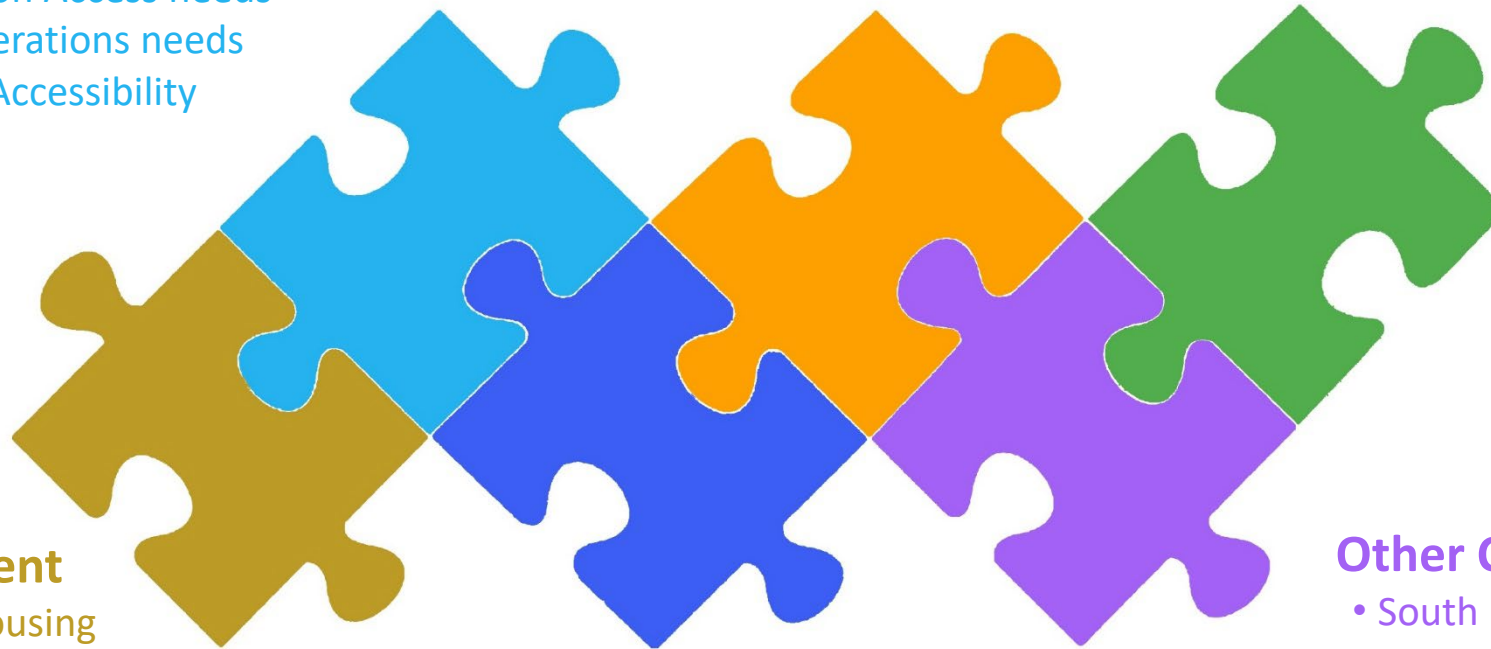

## Option 1 – Plaza with Adeline Bus Lanes

- Dedicated bus lanes
- No westside drop-off or parking
- Shorten crosswalks from ~84 to 60 feet
- Plaza on westside narrower than Option 2

## Option 2 – Plaza with Two-Lane Adeline

- No dedicated bus lanes
- Westside drop-off and parking
- Shorten crosswalks from ~84 to 46 feet
- Plaza on westside wider than Option 1

## Both Options

- One vehicle lane each way
- Protected bikeways
- Buffered bike lane at Ed Roberts Campus
- Bus stop with bicycle bypass at BART
- Redesigned Adeline / MLK Jr. Way intersection
- Potential to expand south end of the plaza

# Option 1 – Plaza with Adeline Bus Lanes

November 29, 2022

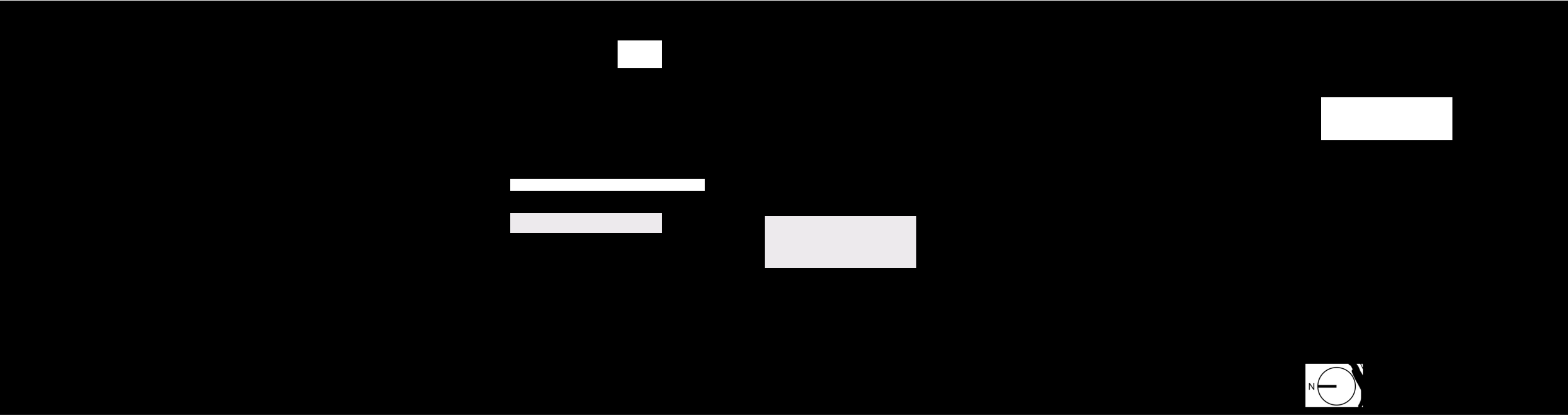

# Option 1 – Ashby Intersection

November 29, 2022

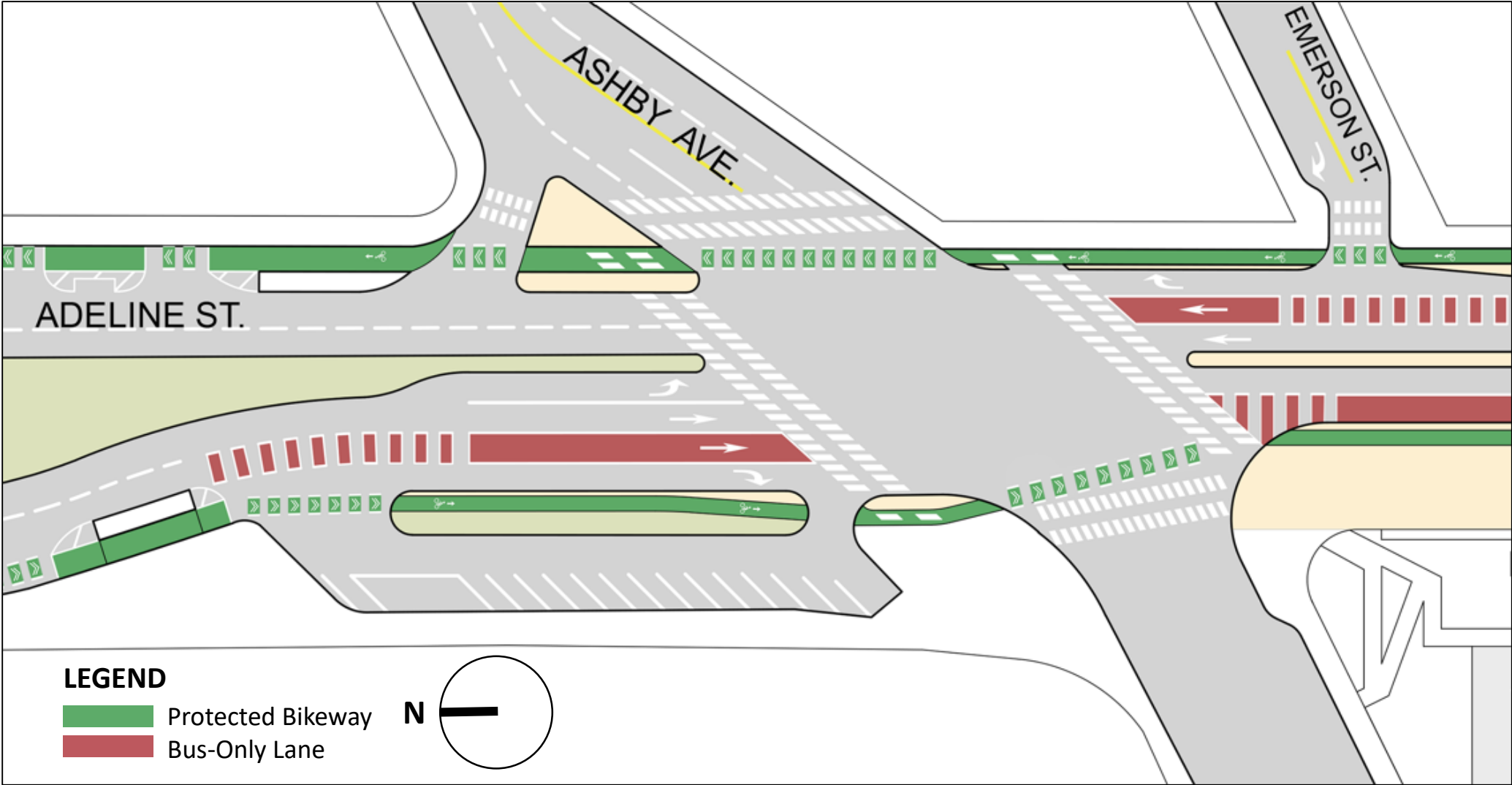



# Option 1 – South of Ashby

November 29, 2022

**LEGEND**

- Protected Bikeway
- Bus-Only Lane

- Plaza
- Bike Zone
- Weekend Vendor Parking/  
Weekday Bus Lane
- Buffer/Plaza/Sidewalk

Section A (Option 1a & 1b)

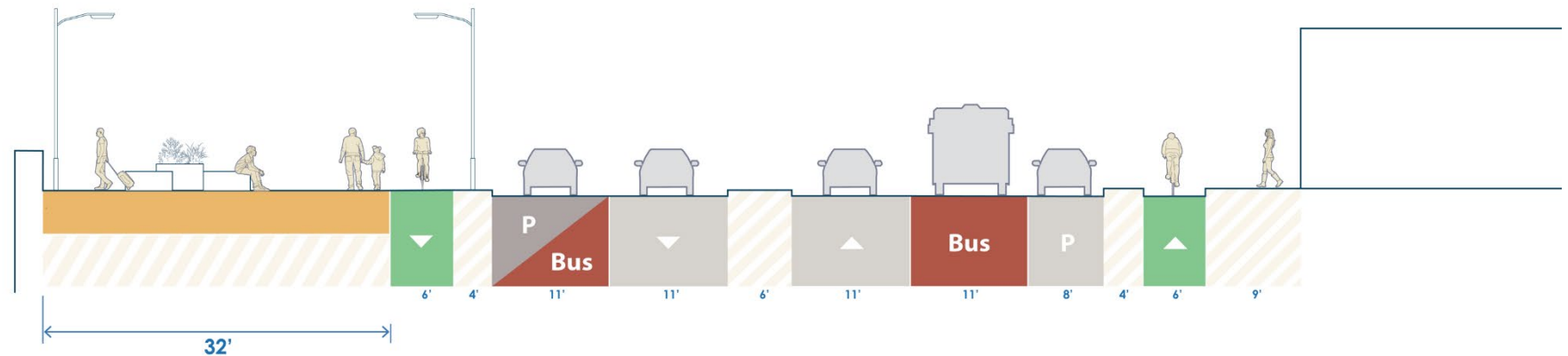

# Option 1 – Plaza Width with and w/o extension

November 29, 2022

-  Plaza
-  Bike Zone
-  Weekend Vendor Parking/  
Weekday Bus Lane
-  Buffer/Plaza/Sidewalk

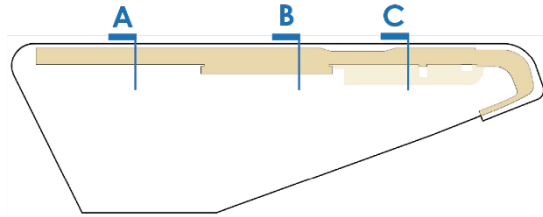

Section A (Option 1a & 1b)

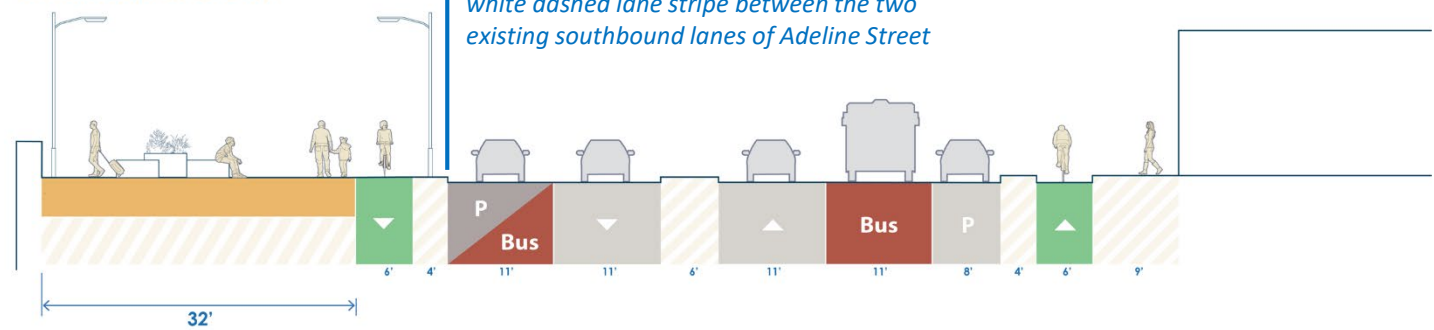

Section B (Option 1a & 1b)

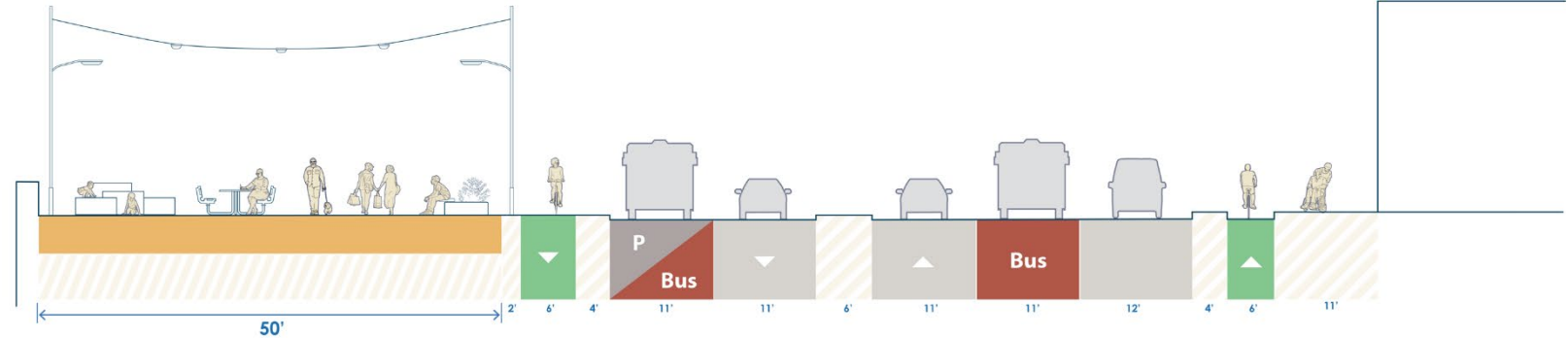

Section C (Option 1b)

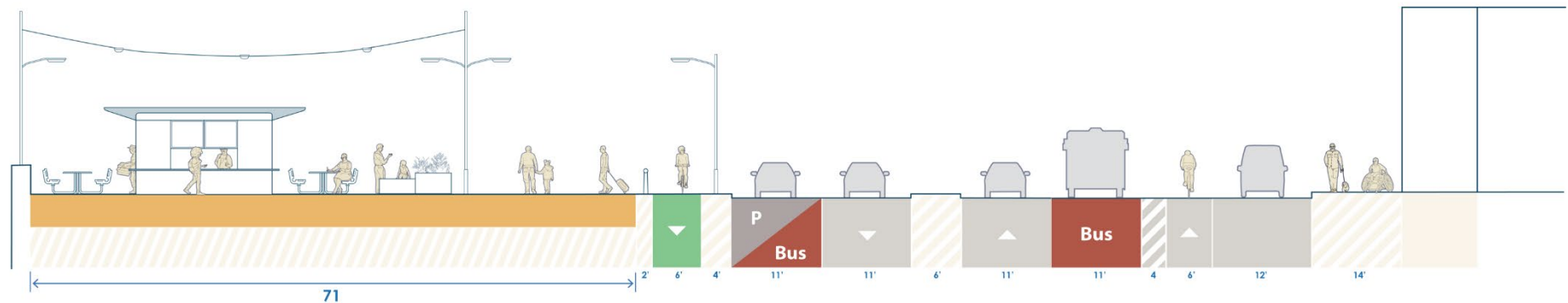

# Option 2 - Plaza with Two-Lane Adeline

November 29, 2022

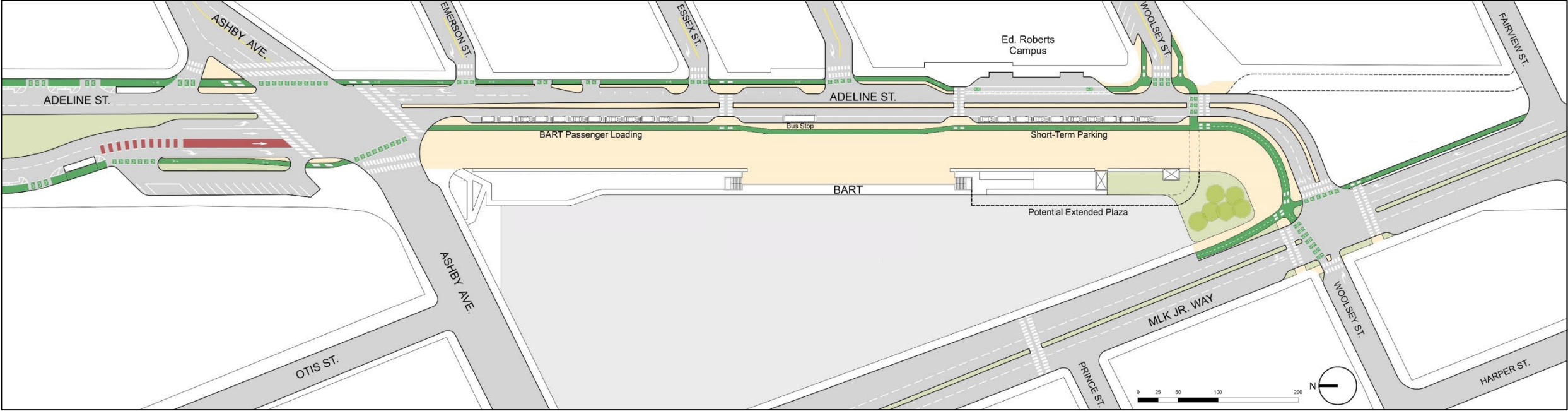

- Legend**
- Protected Bikeway
  - Bus Queue Jump

# Option 2 - Ashby Intersection

November 29, 2022

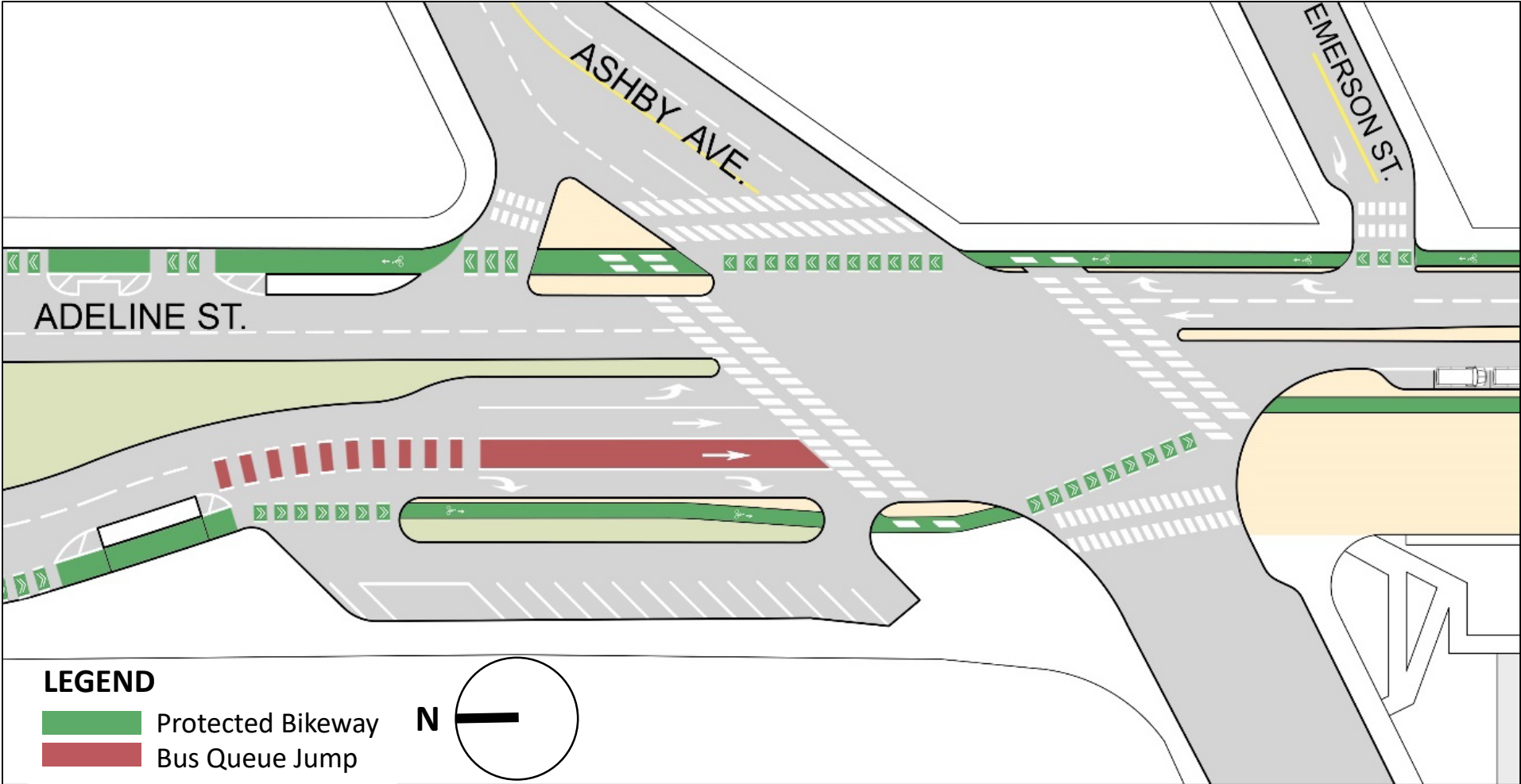

# Option 2 – South of Ashby

November 29, 2022

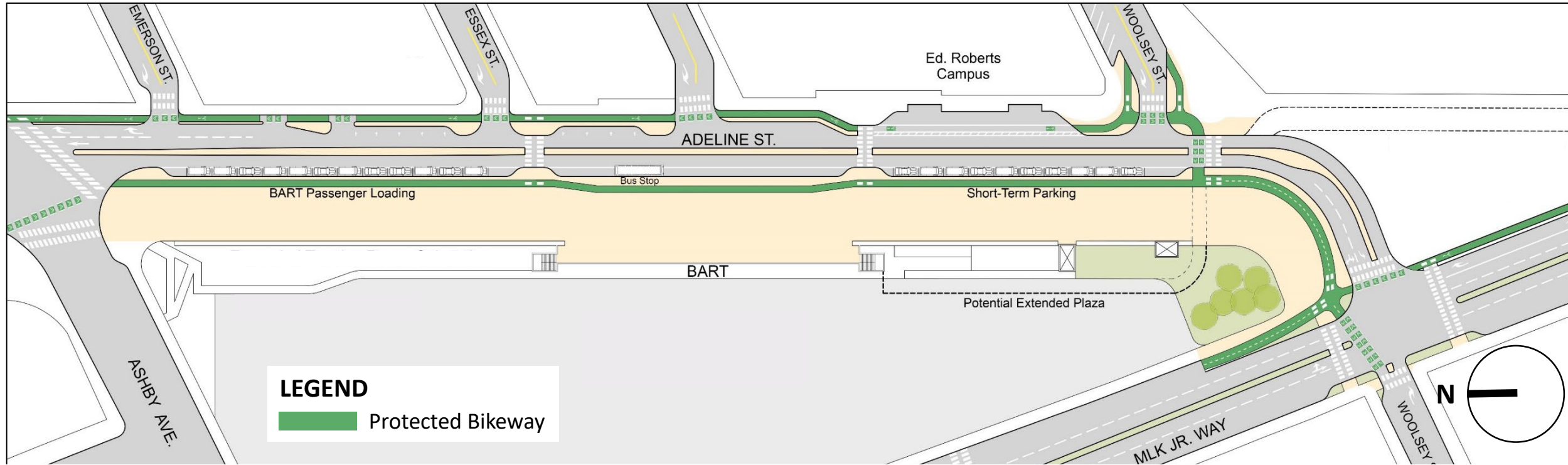

- Plaza
- Bike Zone
- Weekend Vendor Parking/  
Weekday Bus Lane
- Buffer/Plaza/Sidewalk

Section A (Option 2a & 2b)

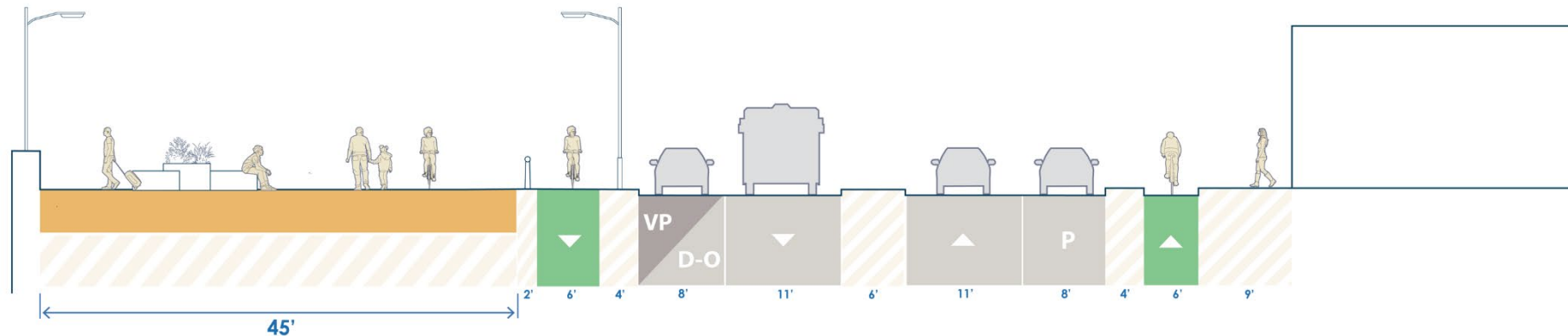

# Option 2 – Plaza Width with and w/o extension

November 29, 2022

-  Plaza
-  Bike Zone
-  Weekend Vendor Parking/  
Weekday Bus Lane
-  Buffer/Plaza/Sidewalk

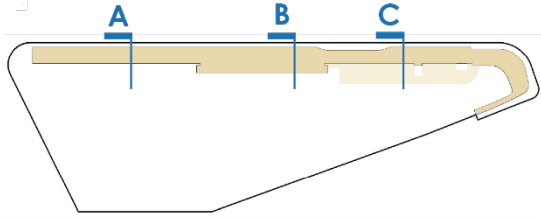

Section A (Option 2a & 2b)

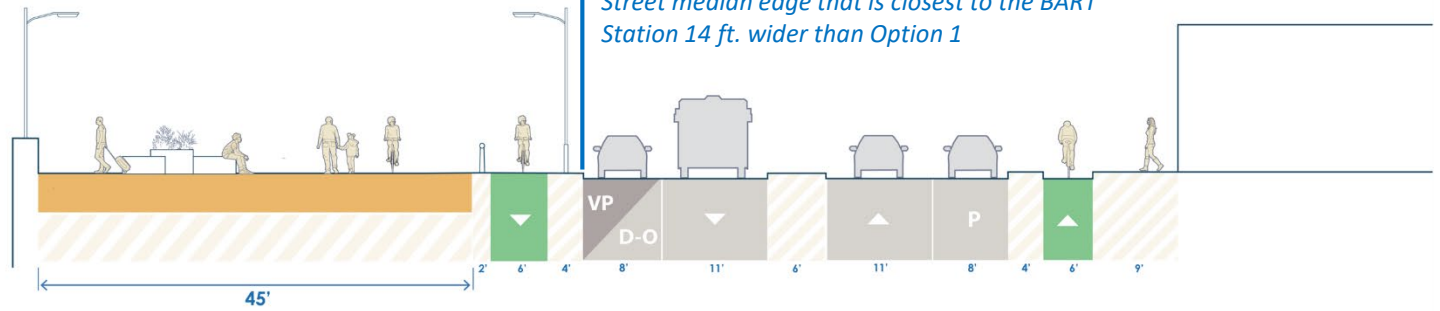

Section B (Option 2a & 2b)

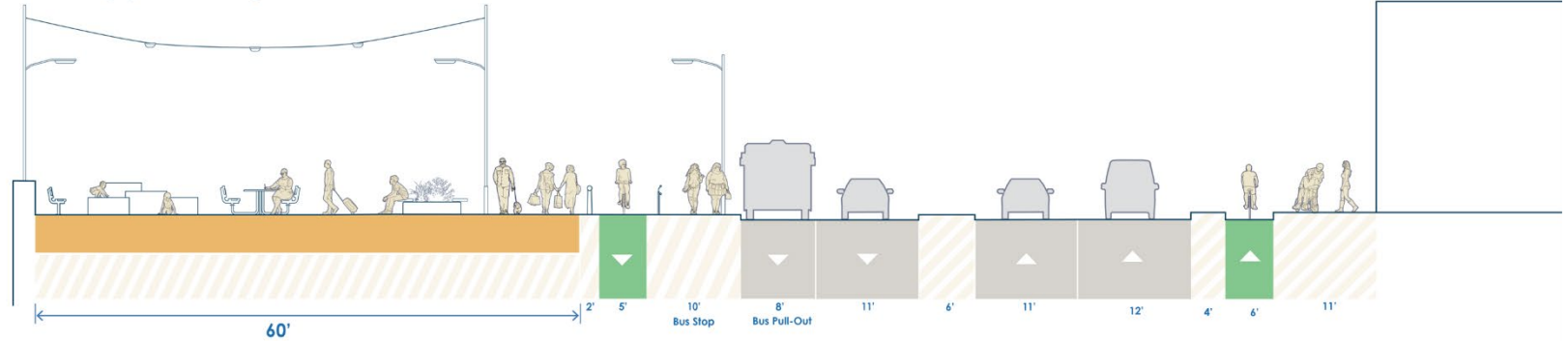

Section C (Option 2b)

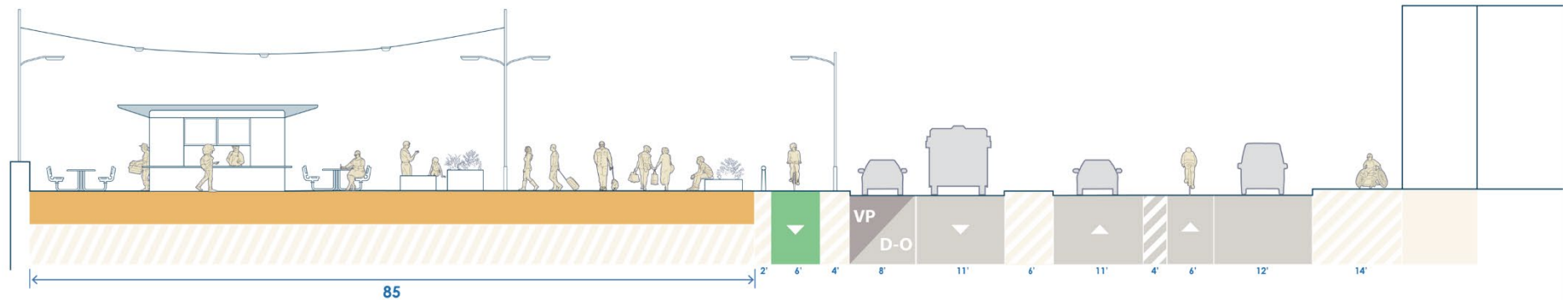

## Traffic speed

- Lane reduction manages speed

## Travel time (with full buildout of Adeline Corridor Specific Plan) compared to existing

- Signal timing adjustments reduce delay
- Adeline/Ashby intersection PM peak delay
  - No increase southbound
  - Less than 10 sec. increase northbound
- Adeline/MLK intersection PM peak delay
  - No delay southbound
  - No delay northbound
- Queue jump and dedicated transit lane improve transit performance

# Plaza – Comparisons

November 29, 2022

940 ft. long, 32, 50 up to 71 ft. wide

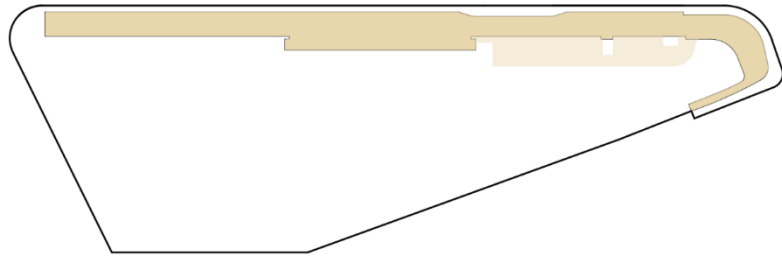

Adeline Plaza Option 1

940 ft. long, 45, 60 up to 85 ft. wide

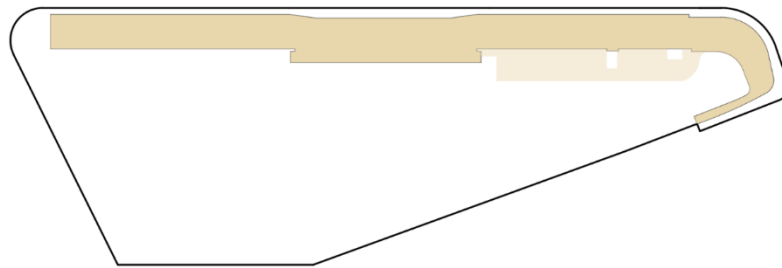

Adeline Plaza Option 2

200 ft. long, 58 to 75 ft. wide

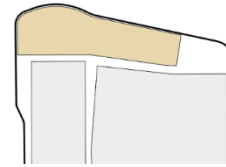

Downtown BART Plaza

680 ft. long, 40 to 55 ft. wide

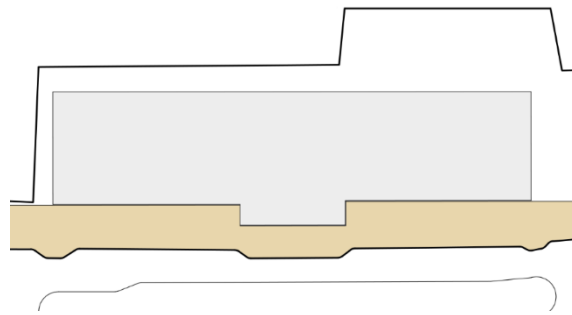

The Embarcadero Promenade  
at Ferry Building, SF





# Plaza – Possible Uses

November 29, 2022

## Uses and activation

### • Daily uses

- Kiosks – coffee, food or local start-ups
- Movable tables and chairs
- Stage – music or other performance
- Yoga, tai chi or other short term uses
- Pop-up kids play area



McLaren Park Tai Chi Court Source: SF Rec and Park

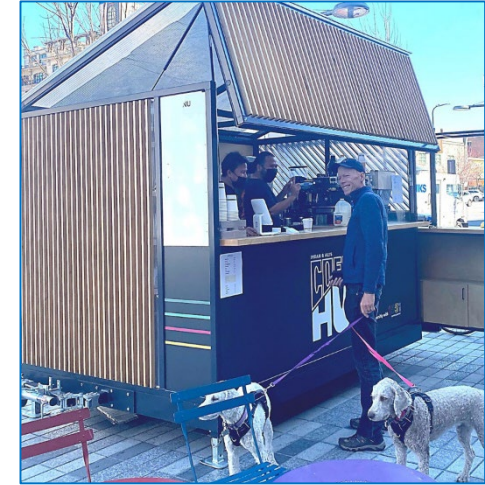

Downtown Berkeley BART Plaza  
Source: Jenni Touli Voss /  
Downtown Berkeley Association

### • Weekend and Special Events

- Berkeley Flea Market
- Seasonal Festivals
- Art Installations
- Seasonal or periodic performance



Source: visitberkeley.com



Source: Anita Liu / Daily Cal

## Design elements, details, and materials to consider in plaza design

- Bollards, railings, or planter boxes between bikeway and plaza
- Lighting
- Information kiosk/boards
- Wayfinding signs
- Planter pots
- Possible all-weather structures
- Fixed or movable seating and tables
- Trash and recycling containers
- Performance Stage
- Power and water
- Plaza surface materials

## Possible features in the plaza or adjacent development

- Public bathrooms
- Public children's play area

## Design of the plaza's western edge—

- Building entries
- Potential for plaza fronting buildings
- Passages into and through future development
- Kiosks or other built space in the plaza
- Railings
- Art or green walls

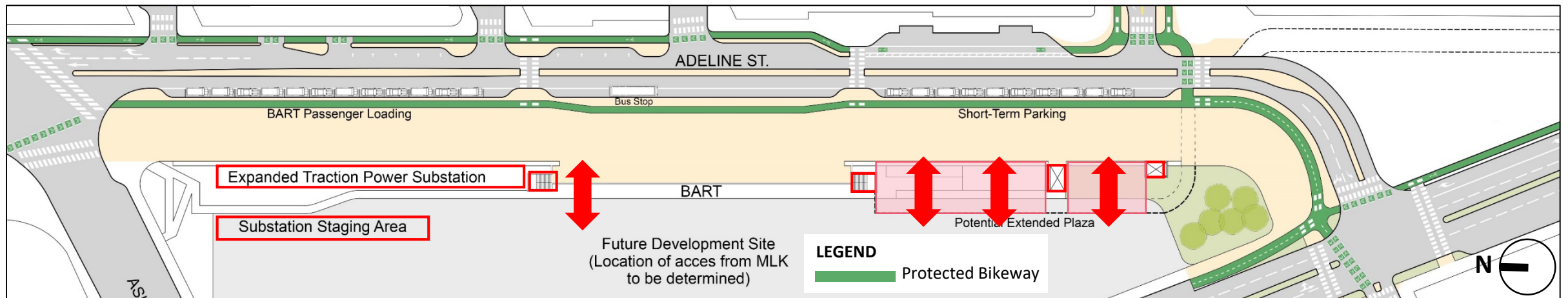

# Common Plaza Features – Artwork

November 29, 2022

## Memorial Wall to acknowledge Flea Market and Lorin District history

- Example locations - walls at: plaza edges; around the redwood tree area; at new exit stair or vent; others to be determined

## Stationary artwork throughout the plaza

- City-Commissioned Mildred Howard sculpture - on plaza (or other future location - TBD)
- Programmed art installations

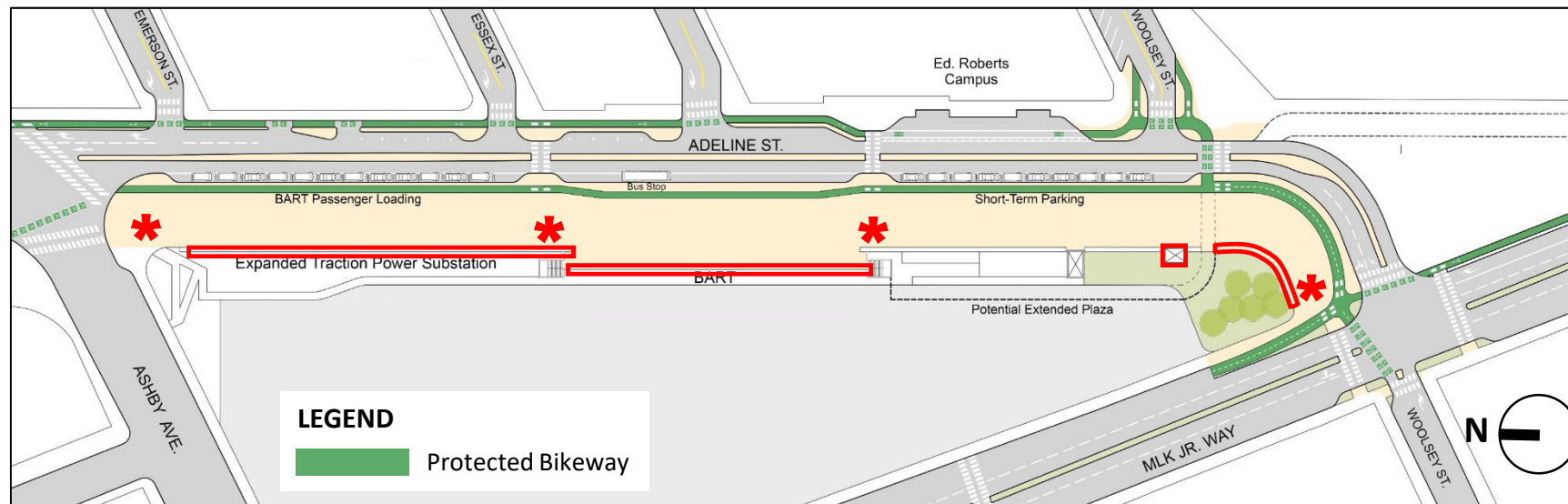

# Discussions with the Berkeley Flea Market

November 29, 2022

- On-going discussions about operations and improvements that can make the plaza work as a permanent home
- Exploring concepts for stall sizing and stall layouts for the plaza options



## OPTION 1

### COMMUNITY INPUT

- Dedicated bus lanes not justified by infrequent F-bus service.
- Focus on improving efficiency for the 12-bus service on MLK Jr. Way.
- Buses traveling along the curb will create sight line problems.
- Dedicated bus lane will be used predominantly by private tech buses.
- Results in less plaza space.

### BERKELEY FLEA MARKET INPUT

- Having a dedicated bus lane will take space from the plaza.

## Staff and Transportation and Infrastructure Commission Recommend OPTION 2

### COMMUNITY INPUT

- Preferred option by several speakers:
  - Slows traffic
  - Shortens crossings
  - Maximizes plaza space
- Will single lane will work for emergency vehicles and buses pull in and pull out?
- “Test drive” narrowing and see how it works before final design and building it.
- Concern about redirection of traffic to MLK and other adjacent streets.

### BERKELEY FLEA MARKET INPUT

- More room for vendor stalls in larger plaza.



**Thank you.**