



Office of the City Manager

RECESS ITEM
CONSENT CALENDAR
September 14, 2021

To: Honorable Mayor and Members of the City Council
From: Dee Williams-Ridley, City Manager
Submitted by: Liam Garland, Director, Department of Public Works
Subject: Contract: ERA Construction, Inc. for 1322 Glendale Avenue Retaining Wall Project

RECOMMENDATION

Adopt a Resolution ratifying the action taken by the City Manager during recess to approve plans and specifications for the 1322 Glendale Avenue Retaining Wall Project, Specification No. 21-11448-C; accept the bid of ERA Construction, Inc. as the lowest responsive and responsible bidder; and execute a contract and any amendments, extensions or other change orders until completion of the project, in accordance with the approved plans and specifications in an amount not to exceed \$1,038,103, which includes a 10% contingency for unforeseen circumstances.

NEGATIVE EFFECT IF ACTION IS DELAYED UNTIL AFTER COUNCIL RECESS

Awarding this construction contract would authorize ERA Construction to proceed with the replacement of a retaining wall along Glendale Avenue. The existing retaining wall's condition has deteriorated since bids were opened on June 8, 2021. It's critical that replacement begins as soon as possible so the new retaining wall can be in place before the upcoming rainy season. Delaying award until after Council recess would extend the construction period into the wet season and lead to increased risk of structural failure.

FISCAL IMPACTS OF RECOMMENDATION

Funding from the Measure BB Sales Tax (Fund 134) and the Capital Improvement Fund (Fund 501) will be requested for carryover as part of the First Amendment to the FY 2022 Annual Appropriations Ordinance. No other funding is required, and no other projects will be delayed due to this expenditure.

Low bid by Contractor	\$943,730
10% Contingency	\$94,373
Total construction cost	\$1,038,103

FY 2022 Funding:

Measure BB Sales Tax (134-54-623-673-0000-000-431-665110)	\$670,000
Capital Improvement Fund (501-54-623-673-0000-000-431-663110)	\$368,103
Total construction cost	\$1,038,103

CURRENT SITUATION AND ITS EFFECTS

The 1322 Glendale Avenue Retaining Wall Project (Specification No. 21-11448-C) was released for bids on May 12, 2021, and bids were opened on June 8, 2021 (see Attachment 3, Abstract of Bids). Four non-local bids were received, from a low of \$943,730 to a high of \$1,151,610. The engineer's estimate for the project was \$880,000. ERA Construction of San Pablo, California was the lowest responsive and responsible bidder, with a bid of \$943,730, and their references were found to be satisfactory. This project includes a 10% contingency, which brings the total contract amount up to the requested \$1,038,103. Staff recommends a contract for this project be awarded to ERA Construction Inc.

The 1322 Glendale Avenue Retaining Wall Project is a Strategic Plan Priority Project, advancing the City's goal to provide state-of-the art, well-maintained infrastructure, amenities, and facilities.

BACKGROUND

Glendale Avenue is a critical access route to the east Berkeley Hills. It's north branch, carved on a hillside overlooking Glendale-La Loma Park, connects La Loma Avenue and Campus Drive. Portions of this section of roadway are supported by a wood crib retaining wall constructed in the 1960's. Over time, poor drainage has led to erosion and sloughing of the soils directly behind the retaining wall eventually leading to the failure of some of its support structure. In 2020 the City retained the services of a geotechnical consultant to perform subsurface investigation and to provide an assessment of the existing retaining wall's structural stability. The conclusions from the investigation were summarized in a geotechnical report which included recommendations to replace portions of the retaining wall within two years. Based on these recommendations, City staff mobilized to retain the services of an engineering consultant to proceed with the design of the replacement wall.

After thorough planning, coordination with utility companies, field investigations, surveys, and a detailed design phase, project plans and specifications were finalized and released for bids. In addition to the retaining wall replacement, the project includes storm, sidewalk, curb & gutter, fencing, and guardrail improvements. The plans and specifications are on file in the Public Works Department.

The Living Wage Ordinance does not apply to this project since Public Works construction contracts are, pursuant to City policy, subject to State prevailing wage laws. ERA Construction has submitted a Certification of Compliance with the Equal Benefits Ordinance. The Community Workforce Agreement applies to this project because the estimated value of the project exceeds \$500,000. As a result, the contractor and all subcontractors will be required to sign an agreement to be bound by the terms of the Agreement.

ENVIRONMENTAL SUSTAINABILITY AND CLIMATE IMPACTS

The project includes storm system improvements which will not only maximize the life of the new retaining wall but also reduce erosion of the hillside at the toe of the wall.

Reduced erosion protects water quality by reducing sediments entering the storm drain system and Codornices Creek downhill of the retaining wall.

The new retaining wall will be constructed of steel piles and precast concrete lagging. These materials are durable and will ensure the new wall has a longer lifespan than the wood crib retaining wall currently in place. The longer lifespan will result in less frequent replacement of the wall and in turn eliminate the construction related greenhouse emissions associated with more frequent replacement.

RATIONALE FOR RECOMMENDATION

This project replaces infrastructure near the end of its useful life. Performing the work requires contracted services, as the City does not possess the in-house labor, equipment, or expertise necessary to complete the project.

ALTERNATIVE ACTIONS CONSIDERED

No alternative actions were considered for this project. Failure to replace the aging retaining wall would result in continued degradation and eventual failure of the wall; placing private property and public infrastructure at risk.

CONTACT PERSON

Joe Enke, Acting Manager of Engineering, (510) 981-6411

Attachments:

- 1: Resolution
- 2: Location Map
- 3: Abstract of Bids

RESOLUTION NO. ##,###-N.S.

CONTRACT: ERA CONSTRUCTION, INC. FOR 1322 GLENDALE AVENUE
RETAINING WALL PROJECT

WHEREAS, an existing retaining wall along a portion of Glendale Avenue between La Loma Avenue and Campus Drive requires replacement; and

WHEREAS, the City does not possess the in-house labor, equipment, or expertise necessary to complete the 1322 Glendale Avenue Retaining Wall Project; and

WHEREAS, an invitation for bids was duly advertised and ERA Construction, Inc. was the lowest responsive and responsible bidder; and

WHEREAS, funding from the Measure BB Sales Tax (Fund 134) and the Capital Improvement Fund (Fund 501) will be requested for carryover as part of the First Amendment to the FY 2022 Annual Appropriations Ordinance.

NOW THEREFORE, BE IT RESOLVED by the Council of the City of Berkeley that the Plans and Specification No. 21-11448-C for the 1322 Glendale Avenue Retaining Wall Project are approved.

BE IT FURTHER RESOLVED that the Council of the City of Berkeley ratifies the action taken by the City Manager during recess to execute a contract and any amendments, extensions or change orders, until completion of the project in accordance with the approved plans and specifications with ERA Construction, Inc. for the 1322 Glendale Avenue Retaining Wall Project, in an amount not to exceed \$1,038,103, which includes a 10% contingency for unforeseen circumstances. A record signature copy of said agreement and any amendments to be on file in the Office of the City Clerk.

LOCATION MAP

1322 GLENDALE AVENUE

RETAINING WALL REPLACEMENT PROJECT

SPECIFICATION NO. 21-11448-C

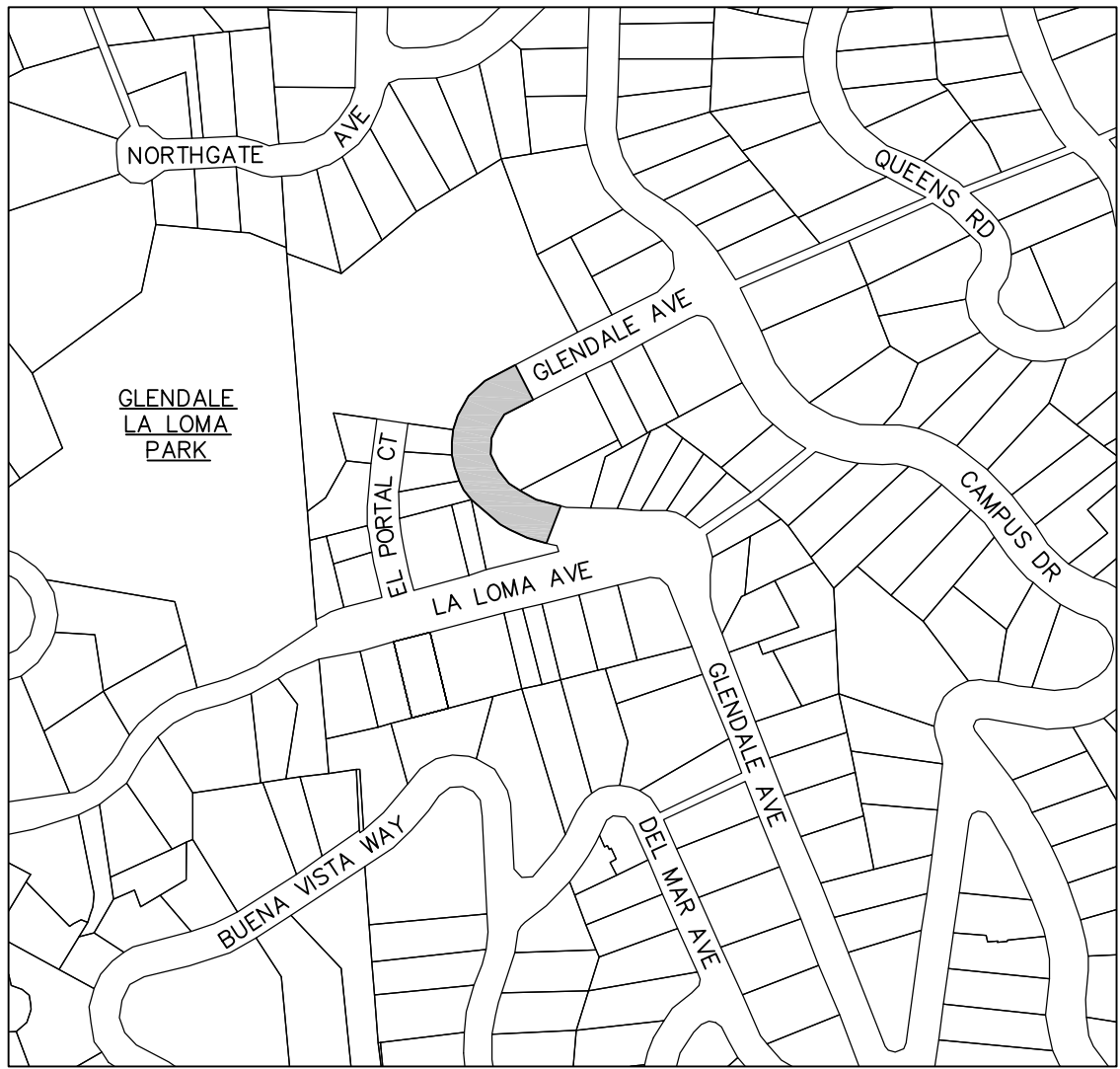

ATTACHMENT 2

 - CONSTRUCTION AREA

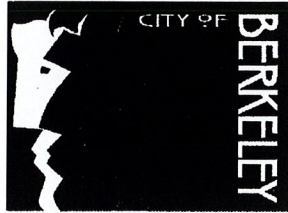

City of Berkeley
Abstract of Bid Worksheet

Finance Department
General Services Division

FOR: Glendale Ave. Retaining Wall

Spec. #
21-11448-C

Bid Date: 6/8/2021

required w/ bid

	Bidders	Base Bid	Bid Bond	Addenda (0)	Exp. & Qual	Tax ID	NF	OS	SC	EBO
1	Azul Works Inc	\$ 1,056,582.00	x		x	x	x	x	x	x
2	Beliveau Engineering	\$ 1,151,610.00	x		x	x	x	x	x	x
3	ERA Construction	\$ <i>RD.</i> 943,729.75 895,284.75	x		x	x	x	x	x	x
4	Kerex Engineering	\$ 1,034,305.00	x		x	x	x	x	x	x
5										
6										
7										
8										
9										
10										

Bid Recorder: Darryl Sweet

Bid Opener: Josh Roben

Project Manager: Ricardo Salcedo

2180 Milvia Street, Berkeley, CA 94704
Tel: 510.981.7320 TDD: 510.981.6903 Fax: 510.981.7390
E-mail: finance@ci.berkeley.ca.us